

FILED FOR RECORD  
IN MY OFFICE

AT 1:30 O'CLOCK A M

MAR 10 2005

MICKEY DORMAN  
COUNTY CLERK, PANOLA COUNTY, TEXAS  
BY Chris Jones DEPUTY

**MEETING OF COMMISSIONERS' COURT  
OF PANOLA COUNTY**

TO WHOM IT MAY CONCERN:

PURSUANT TO THE TEXAS OPEN MEETINGS ACT, NOTICE IS HEREBY GIVEN THAT A REGULAR MEETING OF THE COMMISSIONERS' COURT OF PANOLA COUNTY, TEXAS WILL BE HELD ON THE 14<sup>TH</sup> DAY OF MARCH, 2005, IN THE COMMISSIONERS' COURTROOM IN THE PANOLA COUNTY COURTHOUSE IN CARTHAGE, TEXAS AT 9:00 O'CLOCK A.M. AT WHICH MEETING THE FOLLOWING SUBJECTS WILL BE DISCUSSED AND THE FOLLOWING MATTERS ACTED UPON:

**OPEN MEETING:**

1. **CITIZEN COMMENTS:** This is for citizens to comment on any subject not on the current agenda concerning county business. Members of the Court may answer direct questions, but any action from this item must be scheduled on a future agenda.
2. **COMMISSIONERS' REPORT:** These are for informational purposes only. Any action that needs to be taken on the basis of these reports will be placed on a future agenda for action.
3. **COUNTY JUDGE'S REPORT:** This is for informational purposes only. Any action that needs to be taken on the basis of this report will be placed on a future agenda for action.
4. **CONSENT ITEMS:**

**PERSONNEL**

- a. To record the employment of Brenda Jackson as a Seasonal Communications Officer with the Panola County Sheriff's Department effective February 26, 2005 at the rate of \$10.11 per hour.

**ROAD & BRIDGE**

- a. To record the distance of 197 feet for Claudia Street in Gary.
- b. To approve and record a request by Classic Energy to cross under Panola County Road #401 with a 3" steel line.
- c. To approve and record a request by Hunt Petroleum to cross under Panola County Road #307 with a 3" steel .188 wall line.
- d. To approve and record a request by Lacy Operations, Ltd. to cross under Panola County Road #264 with a 3-1/2" O.D. steel pipe line.
- e. To approve and record a donation from Samson of 62-1/2 yards of SB2 and 62-1/2 yards of SB 3"-5" for Panola County Road #326.

**MISCELLANEOUS**

- a. To approve minutes of Commissioners' Court meetings held during the month of February, 2005.
- b. To approve and record 2005 Budget Amendment No. 4.

**REQUESTS FOR CONFERENCE ATTENDANCE**

- a. To approve and record a Request for Attendance at a Conference form(s) for the following Panola County elected official(s)/employee(s): Panola County Indigent Health Care Coordinator Vianna Cheshire; Panola County Emergency Management Coordinator Ed Brando; Panola County Clerk Mickey Dorman; and Panola County District Clerk Sandra King.
5. To approve Road & Bridge requisitions and to approve payment of current Panola County bills as presented on vouchers prepared and submitted by the County Auditor.
6. To discuss and act upon the employment of Ken Burnum as a Seasonal Operator for the Panola County Road and Bridge Department, Precinct #4, effective March 15, 2005 at the rate of \$12.29 per hour.
7. To discuss and act upon approving an increase in salary to \$9.61 per hour for Danny Porter, Truck Driver, Panola County Road and Bridge Department, Precinct #4, effective March 15, 2005.
8. To discuss and take any action necessary with regards to polling places for the 2006 Election.

**ADJOURNMENT**

WITNESS THE HAND OF THE UNDERSIGNED CLERK ON THIS THE 10<sup>TH</sup> DAY  
OF MARCH, 2005 AT 11:30 O'CLOCK A.M.



Mickey Dorman

MICKEY DORMAN, COUNTY CLERK  
PANOLA COUNTY, TEXAS

By: Clara Jones, Deputy

MICKEY DORMAN, CLERK OF THE COMMISSIONERS' COURT OF PANOLA  
COUNTY, TEXAS DO HEREBY CERTIFY THAT THE ABOVE NOTICE WAS POSTED  
ON THE OFFICIAL BULLETIN BOARD IN THE PANOLA COUNTY COURTHOUSE IN  
THE CITY OF CARTHAGE, TEXAS AND IN A PUBLIC PLACE VISIBLE AT ALL TIMES  
ON THE 10<sup>TH</sup> DAY OF MARCH, 2005 AT 11:30 O'CLOCK A.M.

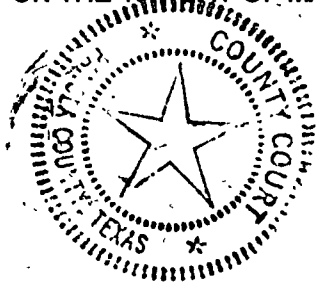

Mickey Dorman

MICKEY DORMAN, COUNTY CLERK  
PANOLA COUNTY, TEXAS

By: Clara Jones, Deputy

FILED FOR RECORD  
IN MY OFFICE

AT 8:00 O'CLOCK 4 M.

APR 13 2005

MICKEY DORMAN  
COUNTY CLERK, PANOLA COUNTY, TEXASBY Mickey Dorman DEPUTYThe State of Texas  
County of Panola

On this the 14th day of March A.D. 2005, the Commissioners' Court of Panola County, Texas met in a Regular Meeting of the Court at 9:00 o'clock a.m. in the Commissioners' Courtroom of said County with the following members of the Court present:

David L Anderson  
Ronnie LaGrone  
Douglas M. Cotton  
Hermon E. Reed, Jr.  
Dale LaGrone

County Judge  
Commissioner, Precinct #1  
Commissioner, Precinct #2  
Commissioner, Precinct #3  
Commissioner, Precinct #4

with none absent, constituting a quorum of the Court. Also attending were Mickey Dorman, County Clerk and Cheyenne Burnham, Floating Secretary out of the office of the County Judge. Attached to and made a part of these Minutes is a list of other attendees and the office or organization that each represents. The following proceedings were held at this meeting:

## OPEN MEETING:

## 1. CITIZEN COMMENTS:

There were no comments from the citizens in attendance.

## 2. COMMISSIONERS' REPORTS:

There were no reports from the Commissioners.

## 3. COUNTY JUDGE'S REPORT:

There was no report from the County Judge.

## 4. CONSENT ITEMS:

## PERSONNEL

- ✓ a. To record the employment of Brenda Jackson as a Seasonal Communications Officer with the Panola County Sheriff's Department effective February 26, 2005 at the rate of \$10.11 per hour.

## ROAD &amp; BRIDGE

- ✓ a. To record the distance of 197 feet for Claudia Street in Gary.
- ✓ b. To approve and record a request by Classic Energy to cross under Panola County Road #401 with a 3" steel line.
- ✓ c. To approve and record a request by Hunt Petroleum to cross under Panola County Road #307 with a 3" steel .188 wall line.
- ✓ d. To approve and record a request by Lacy Operations, Ltd. to cross under Panola County Road #264 with a 3-1/2" O.D. steel pipe line.

- ✓ e. To approve and record a donation from Samson of 62-1/2 yards of SB2 and 62-1/2 yards of SB3"-5" for Panola County Road #326.

#### MISCELLANEOUS

- a. To approve minutes of Commissioners' Court meetings held during the month of February, 2005.
- ✓ b. To approve and record 2005 Budget Amendment No. 4.

#### REQUESTS FOR CONFERENCE ATTENDANCE

- ✓ a. To approve and record a Request for Attendance at a Conference form(s) for the following Panola County elected official(s)/employee(s): Panola County Indigent Health Care Coordinator Vianna Cheshire; Panola County Emergency Management Coordinator Ed Brando; Panola County Clerk Mickey Dorman and Panola County District Clerk Sandra King.

Commissioner Ronnie LaGrone moved and Commissioner Dale LaGrone seconded the motion to approve all the Consent Items. The motion passed unanimously.

A COPY OF EACH AMENDMENT REQUEST AND/OR BOND IS ATTACHED TO AND MADE A PART OF THE MINUTES.

- ✓ 5. Commissioner Reed moved and Commissioner Dale LaGrone seconded the motion to approve the Road & Bridge requisitions and to approve the payment of the current Panola County bills as presented on vouchers prepared and submitted by the County Auditor. The motion passed unanimously. SEE LIST OF BILLS ATTACHED.
- ✓ 6. After some discussion Commissioner Dale LaGrone moved and Commissioner Ronnie LaGrone seconded the motion to approve the employment of Ken Burnum as a Seasonal Operator for the Panola County Road and Bridge Department, Precinct #4, effective March 15, 2005 at the rate of \$12.29 per hour. The motion passed unanimously. SEE COPY OF REQUEST ATTACHED.
- ✓ 7. After some discussion Commissioner Dale LaGrone moved and Commissioner Cotton seconded the motion to approve an increase in salary to \$9.61 per hour for Danny Porter, Truck Driver, Panola County Road and Bridge Department, Precinct #4, effective March 15, 2005. The motion passed unanimously. SEE COPY OF REQUEST ATTACHED.
- 8. There was discussion concerning changes to polling places for the 2006 Election. No action was taken at this time. There will be an item on the next agenda to finalize this matter after the Commissioners have final confirmation on a couple of possible moves.

The meeting was then adjourned.

Dated this the 14th day of March, 2005.

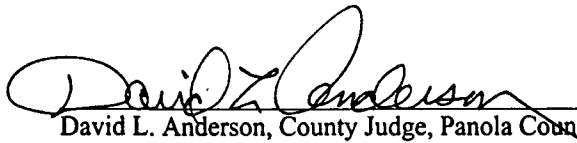
  
David L. Anderson, County Judge, Panola County, Texas

ATTEST:

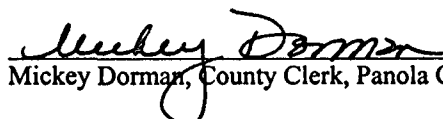
  
Mickey Dorman, County Clerk, Panola County, Texas



VOL. 49 PAGE 6

14 March 2005

9:00 am

Bonita Phillips  
John A. Phillips  
J. A. Phillips

# CONSENT ITEMS

314 W. WELLINGTON  
CARTHAGE, TX 75633  
(903) 693-0333  
FAX (903) 693-9368



JACK ELLETT  
SHERIFF

## PANOLA COUNTY SHERIFF'S DEPARTMENT

February 28, 2005

The Honorable David Anderson  
Panola County Judge  
110 S. Sycamore  
Carthage, Texas 75633

Judge Anderson:

Please add the following amended request to the February 28 , 2005 agenda scheduled Commissioner's meeting:

- 1) Record the employment of Brenda Jackson as a Seasonal Dispatcher for the Panola County Sheriff's Office, 10.11 per hour Effective February 26, 2005.

Sincerely,

A handwritten signature in black ink, appearing to read "Jack Ellett".

Jack Ellett  
Sheriff

JE/cs

CC: Sidney Burns  
Gloria Portman

HONESTY - INTEGRITY - DEDICATION



NOTICE OF PROPOSED INSTALLATION  
PIPELINE AND /OR UTILITY LINES

TO: THE PANOLA COUNTY COMMISSIONERS COURT

c/o

PANOLA COUNTY ROAD & BRIDGE DEPARTMENT CARTHAGE, TEXAS

Formal notice is hereby give that:

Classic Proposes to place a  
(COMPANY NAME)

8" steel Line within the Right-of-Way  
(PIPE SIZE)

of County Road: 401 as follows:  
(NUMBER OF ROAD)

The proposed pipeline will cross under the indicated roads on the attached sheet.  
Installation shall be made by boring total length of line in Panola County is 160 Feet.

The location and description of the proposed line and appurtenances is more fully shown by the copies of the drawings attached to this notice. The line will be constructed and maintained on the County Right-of-Way as directed by the County Commissioners in accordance with current Panola County Specifications.

Construction of this line will begin on or after the 10<sup>th</sup> day of March 2004.

FIRM: Courtney Construction  
BY: Craig Pittman  
TITLE: Supervisor  
ADDRESS: 2617 US 29 North  
Carthage, TX 75633  
PHONE: (903) 694-2911

**SPECIAL SPECIFICATIONS  
FOR PIPE LINES CROSSING IN BORED HOLES  
AND PLACED PARALLEL TO COUNTY ROADS**

**GENERAL NOTE:** The construction of this project shall follow "The Panola County Road and Bridge Department Standard Specifications" with respect To barricades, flagmen, flares, warning signs, and all responsibility for complaints or damage suits by traveling public and adjacent property owners.

1. Exaction material shall not be placed on road shoulders or traffic lanes or in ditches where drainage would be impaired. When excavation is permitted near the roadway where, in the opinion of the County, the support of the oil road structure is endangered, sheeting, cribbing, other measures shall be taken to prevent damage to the roadway or the creation of traffic hazard.
2. All excavations shall be backfilled in a neat and workmanlike manner and all disturbed areas shall be restored to a condition comparable to the original condition. Backfill material shall be consolidated to a density comparable to that of the adjacent undisturbed material, replacing all of the excavated material except that displaced by pipe. The degree of compaction shall be such as to prevent future settlement. Excess material displaced by the pipe shall be remove from the right-of-way or otherwise disposed of to the satisfaction of the county's representative. Pipe laying operation shall not be carried on when soil conditions are such that construction equipment will cause rutting. Backfill operations shall be kept within one mile of trenching and/or pipe laying operations.
3. Sod and/or other erosion control measures removed or disturbed by the installation shall be replaced. This shall include keeping separate and replacing existing topsoil, importing sod or seeding or a combination of these methods together with fertilizer and water as necessary to re-establish vegetative cover in a healthy and growing condition.
4. The pipe or, if encased, the encasement pipe shall completely fit the bored hole.
5. All private and commercial access driveways disturbed by pipe laying shall be restored to a condition comparable to that which existed prior to these operation. Special care shall be taken to compact backfill and base material to prevent future settlement. All work shall be completed to the owners satisfaction. All public access driveways with paved surfaces shall be crossed by the bored hole method. Crossings of dirt or gravel public access driveways may be made as specified for private and commercial access driveways except that provisions shall be made for uninterrupted flow of traffic.

6. No trees or shrubbery shall be cut or trimmed with the approval of the Panola County Road and Bridge Department.
7. Regulations and ordinances of incorporated cities shall be complied with if with the city limits.

## APPROVAL

March 14, 2005

TO: Classic Energy  
c/o Courtney Construction  
2617 U. S. 79 North  
Carthage, Texas 75633

RE: CR #401

The Panola County Commissioners' Court offers no objection to the location on the right-of-way of your proposed 3" steel line as shown by accompanying drawings and notice except as noted below:

It is expressly understood that the County Commissioners' Court does not purpose hereby, to grant any right, claim, title or easement in or upon this county road. It is further understood that in the future should for any reason the county need to work, improve, relocate, widen, increase, add to, or in any manner change the structure of this right-of-way, any required relocation of said lines shall be at the sole expense of owner.

All work on the county right-of-way shall be performed in accordance with the county instructions. The installations shall not damage any part of the road and adequate provisions must be made to cause minimum inconvenience to traffic and adjacent owners. Special specifications for placing this line are as follows:

1. All lines are to be installed a minimum of 36 inches below the flow line of the adjacent drainage or barrow ditch.
2. All excavation within the right-of-way and not under surfacing shall be backfilled by tamping in 6 inch horizontal layers. All surplus material shall be removed from the right-of-way and the excavation finished flush with surrounding natural ground.
3. Lines crossing under surfaced roads and under surfacing cross roads within the right-of-way shall be placed by boring. Boring shall extend from crown line to crown line. Gravity from sewer lines under roadways shall be cast iron pipe.
4. All lines, where practicable, shall be located to cross roadbed at approximately right angles thereto. No lines are to be installed under or within 50 feet of either end of any bridge. No lines shall be placed in any culvert or within 10 feet of the closest point of same.

5. Parallel line will be installed as near the right-of-way lines as is possible and no parallel line will be installed in the roadbed or between the drainage ditch and the roadbed without special permission of the Panola County Commissioners' Court.
6. Operations along roadbeds shall be performed in such manner that all excavated material be kept off the pavement at all times, as well as all operating equipment and materials. No equipment or installation procedures will be used which will damage any road surface or structures. The cost of any repairs to road surface, roadbed, structures or other right-of-way features as a direct result of this installation will be borne by the owner of this line.
7. Barricades, warning signs, lights, and flag man(men) when necessary shall be provided by the contractor or owner. One-half (1/2) of the traveled portion of the road must be open at all times.

Approved: David Z. Anderson  
COUNTY JUDGE

COMMISSIONERS:

Precinct #1	Ronnie LaGrone
Precinct #2	Doug Cotton
Precinct #3	Hermon E. Reed, Jr.
Precinct #4	Dale LaGrone

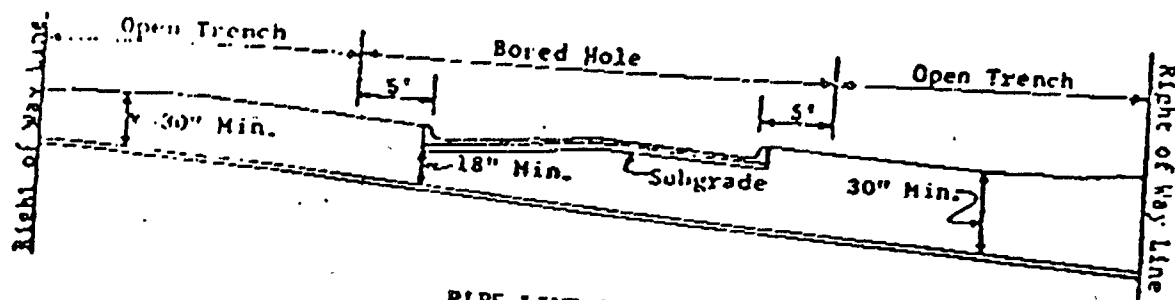
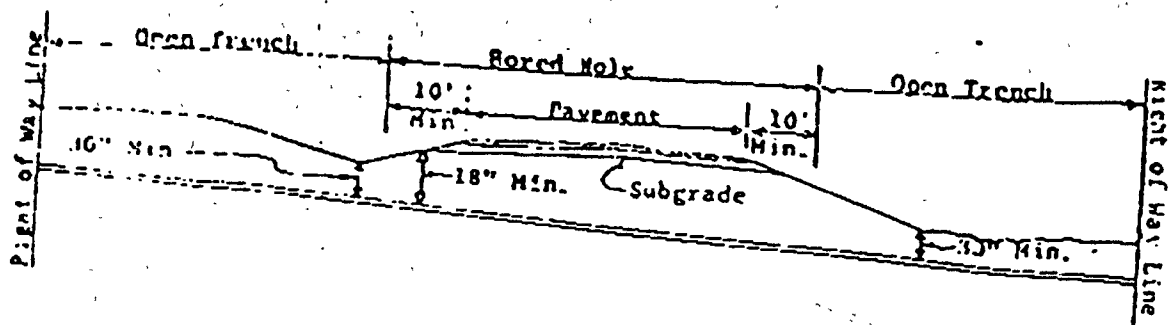

PIPE LINE CROSSING

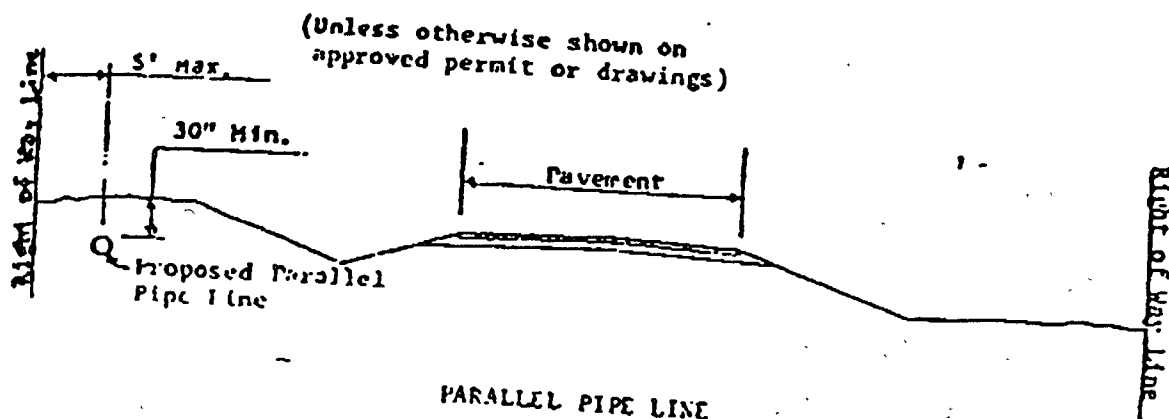

PARALLEL PIPE LINE

(Unless otherwise shown on approved permit or drawings)

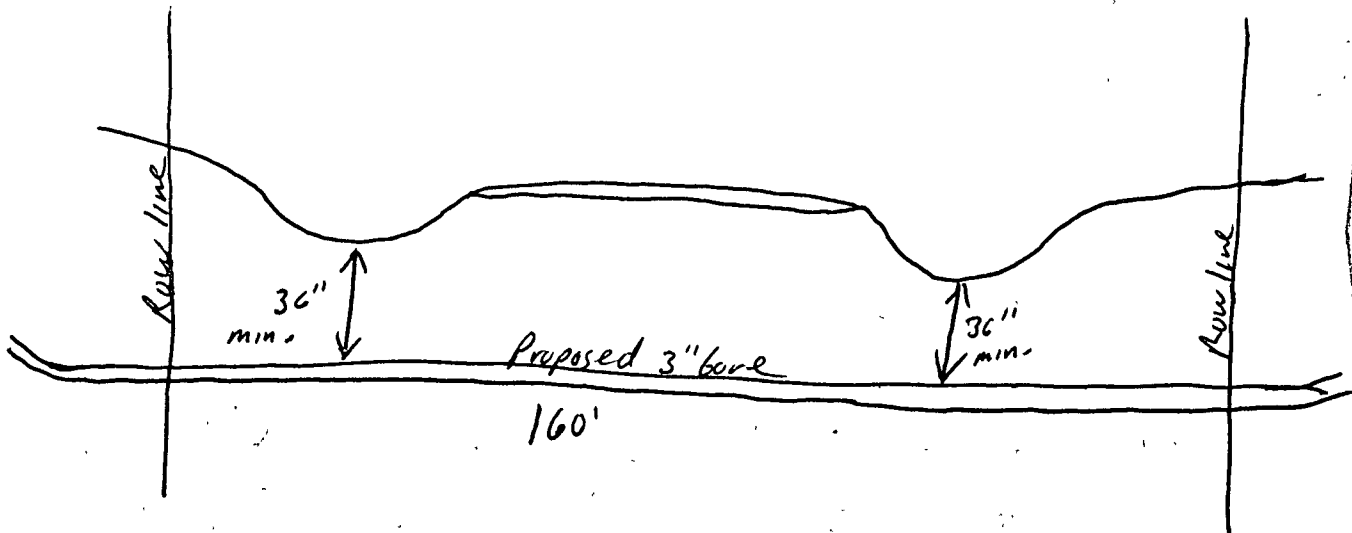

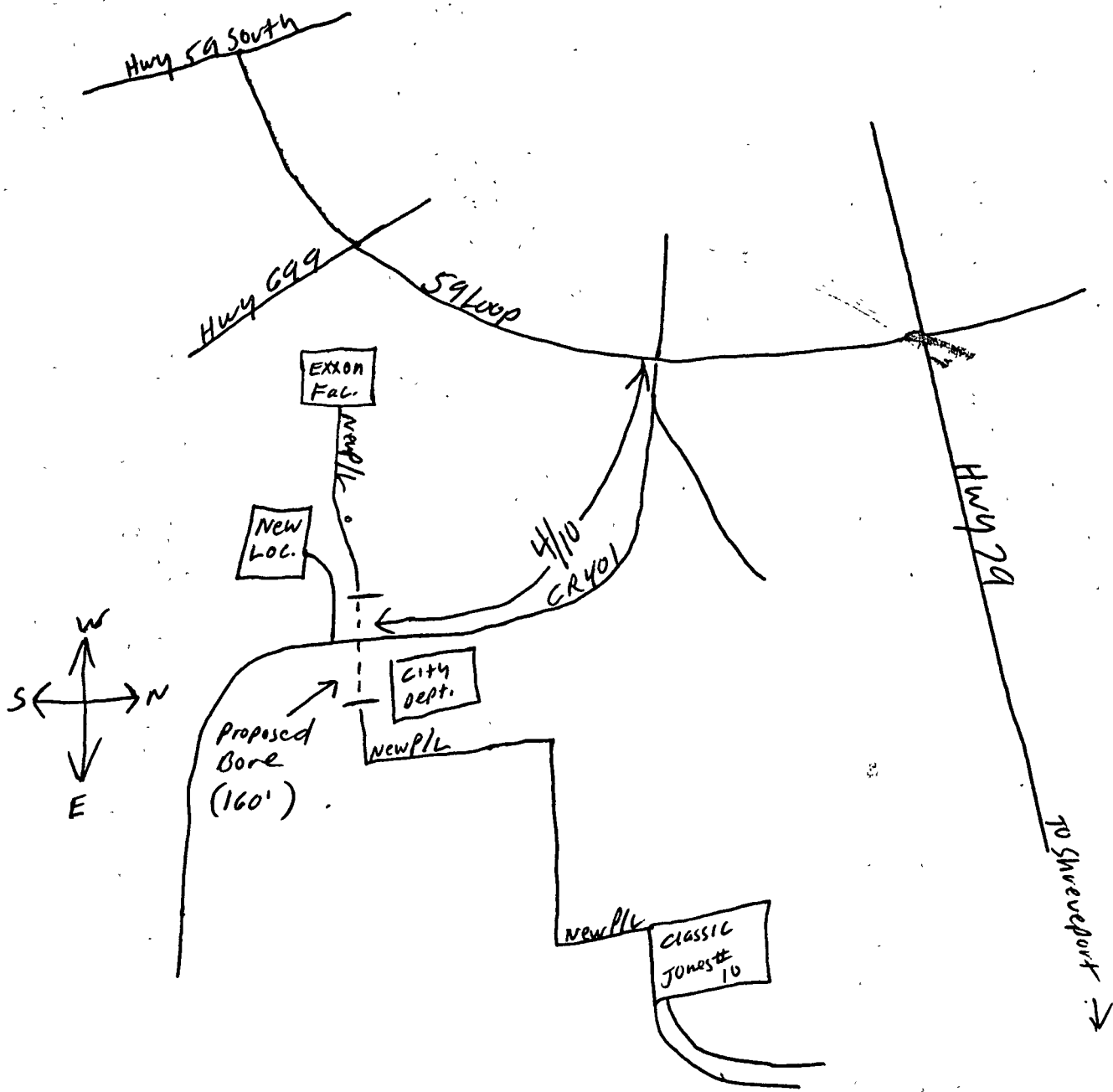



VOL.

49 PAGE

17

021

**NOTICE OF PROPOSED INSTALLATION  
PIPELINE AND /OR UTILITY LINES**TO: THE PANOLA COUNTY COMMISSIONERS COURT

c/o

PANOLA COUNTY ROAD & BRIDGE DEPARTMENT CARTHAGE, TEXAS

Formal notice is hereby give that.

HUNT Petroleum

(COMPANY NAME)

Propos:s to place a

3" Steel 188 wall

(PIPE SIZE)

Line within the Right-of-Way

of County Road:

CR 307

(NUMBER OF ROAD)

as follows:

The proposed pipeline will cross under the indicated roads on the attached sheet.  
Installation shall be made by boring total length of line in Panola County is 320 FT.

The location and description of the proposed line and appurtenances is more fully  
shown by the copies of the drawings attached to this notice. The line will be constructed  
and maintained on the County Right-of-Way as directed by the County Commissioners  
in accordance with current Panola County Specifications.

Construction of this line will begin on or after the

8th

day of

MARCH

2005.

FIRM: 1 GRAND BLUFF CONST.BY: BUTCH DOWNSTITLE: FOREMANADDRESS: 4469 Hwy 59 NBeckville, TX 75631PHONE: (903) 693 7886

18

49 PAGE

VOL.

**SPECIAL SPECIFICATIONS  
FOR PIPE LINES CROSSING IN BORED HOLES  
AND PLACED PARALLEL TO COUNTY ROADS**

**GENERAL NOTE:** The construction of this project shall follow "The Panola County Road and Bridge Department Standard Specification:" with respect To barricades, flagmen, flares, warning signs, and all responsibility for complaints or damage suits by traveling public and adjacent property owners

1. Exaction material shall not be placed on road shoulders or traffic lanes or in ditches where drainage would be impaired. When excavation is permitted near the roadway where, in the opinion of the County, the support of the oil road structure is endangered, sheeting, cribbing, other measures shall be taken to prevent damage to the roadway or the creation of traffic hazard.
2. All excavations shall be backfilled in a neat and workmanlike manner and all disturbed areas shall be restored to a condition comparable to the original condition. Backfill material shall be consolidated to a density comparable to that of the adjacent undisturbed material, replacing all of the excavated material except that displaced by pipe. The degree of compaction shall be such as to prevent future settlement. Excess material displaced by the pipe shall be remove from the right-of-way or otherwise disposed of to the satisfaction of the county's representative. Pipe laying operation shall not be carried on when soil conditions are such that construction equipment will cause rutting. Backfill operations shall be kept within one mile of trenching and/or pipe laying operations.
3. Sod and/or other erosion control measures removed or disturbed by the installation shall be replaced. This shall include keeping separate and replacing existing topsoil, importing sod or seeding or a combination of these methods together with fertilizer and water as necessary to re-establish vegetative cover in a healthy and growing condition.
4. The pipe or, if encased, the encasement pipe shall completely fit the bored hole.
5. All private and commercial access driveways disturbed by pipe laying shall be restored to a condition comparable to that which existed prior to these operation. Special care shall be taken to compact backfill and base material to prevent future settlement. All work shall be completed to the owners satisfaction. All public access driveways with paved surfaces shall be crossed by the bored hole method. Crossings of dirt or gravel public access driveways may be made as specified for private and commercial access driveways except that provisions shall be made for uninterrupted flow of traffic.

3-01-2005 2:04PM

FROM PANOLA COMMISSIONERS 903 693 0342

P. 5

VOL. 49 PAGE 19

roadbed, structures or other right-of-way features as a direct result of this installation will be borne by owner of this line

7. Barricades, warning signs and lights, and flagmen when necessary shall be provided by the contractor or owner. One-half of the traveled portion of the road must be open at all times.

APPROVED: \_\_\_\_\_

COUNTY JUDGE: \_\_\_\_\_

COMMISSIONERS:

Precinct #1 Ronnie LaGrone  
Precinct #2 Doug Cotton  
Precinct #3 Herman Reed  
Precinct #4 Dale LaGrone

## APPROVAL

March 14, 2005

TO: Hunt Petroleum  
c/o Grand Bluff Construction  
4464 Hwy. 59 N  
Beckville, Texas 75631

RE: CR #307

The Panola County Commissioners' Court offers no objection to the location on the right-of-way of your proposed 3" steel .188 wall line as shown by accompanying drawings and notice except as noted below:

It is expressly understood that the County Commissioners' Court does not purpose hereby, to grant any right, claim, title or easement in or upon this county road. It is further understood that in the future should for any reason the county need to work, improve, relocate, widen, increase, add to, or in any manner change the structure of this right-of-way, any required relocation of said lines shall be at the sole expense of owner.

All work on the county right-of-way shall be performed in accordance with the county instructions. The installations shall not damage any part of the road and adequate provisions must be made to cause minimum inconvenience to traffic and adjacent owners. Special specifications for placing this line are as follows:

1. All lines are to be installed a minimum of 36 inches below the flow line of the adjacent drainage or barrow ditch.
2. All excavation within the right-of-way and not under surfacing shall be backfilled by tamping in 6 inch horizontal layers. All surplus material shall be removed from the right-of-way and the excavation finished flush with surrounding natural ground.
3. Lines crossing under surfaced roads and under surfacing cross roads within the right-of-way shall be placed by boring. Boring shall extend from crown line to crown line. Gravity from sewer lines under roadways shall be cast iron pipe.
4. All lines, where practicable, shall be located to cross roadbed at approximately right angles thereto. No lines are to be installed under or within 50 feet of either end of any bridge. No lines shall be placed in any culvert or within 10 feet of the closest point of same.

5. Parallel line will be installed as near the right-of-way lines as is possible and no parallel line will be installed in the roadbed or between the drainage ditch and the roadbed without special permission of the Panola County Commissioners' Court.
6. Operations along roadbeds shall be performed in such manner that all excavated material be kept off the pavement at all times, as well as all operating equipment and materials. No equipment or installation procedures will be used which will damage any road surface or structures. The cost of any repairs to road surface, roadbed, structures or other right-of-way features as a direct result of this installation will be borne by the owner of this line.
7. Barricades, warning signs, lights, and flag man(men) when necessary shall be provided by the contractor or owner. One-half (1/2) of the traveled portion of the road must be open at all times.

Approved: David H. Anderson  
COUNTY JUDGE

COMMISSIONERS:

Precinct #1 Ronnie LaGrone  
Precinct #2 Doug Cotton  
Precinct #3 Hermon E. Reed, Jr.  
Precinct #4 Dale LaGrone

GRAND BLUFF  
CONTRACTOR

HUNT Petroleum  
Company

CR 307

From FM RD 1186 SOUTH  
TO CR 307 TURN RIGHT  
GO 1.7 miles to BORE SITE

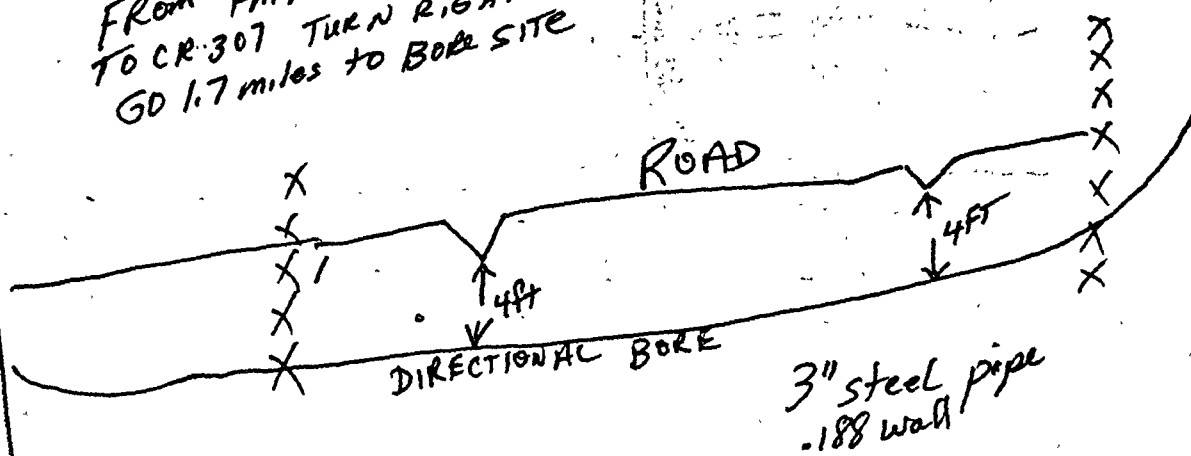

TOTAL BORE 320'  
4 ft depth under ditches

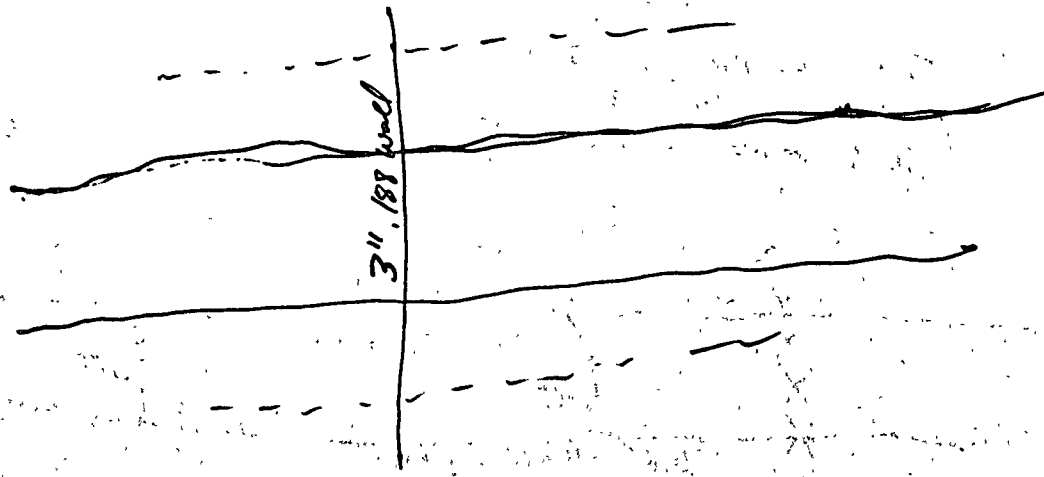

NOTICE OF PROPOSED INSTALLATION  
PIPE AND /OR UTILITY LINES

TO: THE PANOLA COUNTY COMMISSIONERS COURT

c/o

PANOLA COUNTY ROAD & BRIDGE DEPARTMENT CARTHAGE, TEXAS

Formal notice is hereby give that:

Lacy Operations, Ltd.  
(COMPANY NAME)

Proposes to place a

3 1/2" O.D. Steel Pipe  
(PIPE SIZE)

Line within the Right-of-Way

of County Road: 264

(NUMBER OF ROAD)

as follows:

The proposed pipeline will cross under the indicated roads on the attached sheet.  
Installation shall be made by boring total length of line in Panola County is 40'

The location and description of the proposed line and appurtenances is more fully shown by the copies of the drawings attached to this notice. The line will be constructed and maintained on the County Right-of-Way as directed by the County Commissioners in accordance with current Panola County Specifications.

Construction of this line will begin on or after the 16th day of  
March 2005.

FIRM: Lacy Operations, Ltd.

BY: Timothy C. Meyer

TITLE: Agent

ADDRESS: 222 East Tyler Street  
Longview, Texas 75601

PHONE: ( 903 ) 758-8276



**SPECIAL SPECIFICATIONS  
FOR PIPE LINES CROSSING IN BORED HOLES  
AND PLACED PARALLEL TO COUNTY ROADS**

**GENERAL NOTE:** The construction of this project shall follow "The Panola County Road and Bridge Department Standard Specifications" with respect To barricades, flagmen, flares, warning signs, and all responsibility for complaints or damage suits by traveling public and adjacent property owners.

1. Exaction material shall not be placed on road shoulders or traffic lanes or in ditches where drainage would be impaired. When excavation is permitted near the roadway where, in the opinion of the County, the support of the oil road structure is endangered, sheeting, cribbing, other measures shall be taken to prevent damage to the roadway or the creation of traffic hazard.
2. All excavations shall be backfilled in a neat and workmanlike manner and all disturbed areas shall be restored to a condition comparable to the original condition. Backfill material shall be consolidated to a density comparable to that of the adjacent undisturbed material, replacing all of the excavated material except that displaced by pipe. The degree of compaction shall be such as to prevent future settlement. Excess material displaced by the pipe shall be remove from the right-of-way or otherwise disposed of to the satisfaction of the county's representative. Pipe laying operation shall not be carried on when soil conditions are such that construction equipment will cause rutting. Backfill operations shall be kept within one mile of trenching and/or pipe laying operations.
3. Sod and/or other erosion control measures removed or disturbed by the installation shall be replaced. This shall include keeping separate and replacing existing topsoil, importing sod or seeding or a combination of these methods together with fertilizer and water as necessary to re-establish vegetative cover in a healthy and growing condition.
4. The pipe or, if encased, the encasement pipe shall completely fit the bored hole.
5. All private and commercial access driveways disturbed by pipe laying shall be restored to a condition comparable to that which existed prior to these operation. Special care shall be taken to compact backfill and base material to prevent future settlement. All work shall be completed to the owners satisfaction. All public access driveways with paved surfaces shall be crossed by the bored hole method. Crossings of dirt or gravel public access driveways may be made as specified for private and commercial access driveways except that provisions shall be made for uninterrupted flow of traffic.

6. No trees or shrubbery shall be cut or trimmed with the approval of the Panola County Road and Bridge Department.
7. Regulations and ordinances of incorporated cities shall be complied with if with the city limits.

## APPROVAL

March 14, 2005

TO: Lacy Operations, Ltd.  
222 East Tyler Street  
Longview, Texas 75601

RE: CR #264

The Panola County Commissioners' Court offers no objection to the location on the right-of-way of your proposed 3-1/2" O.D. steel pipe line as shown by accompanying drawings and notice except as noted below:

It is expressly understood that the County Commissioners' Court does not purpose hereby, to grant any right, claim, title or easement in or upon this county road. It is further understood that in the future should for any reason the county need to work, improve, relocate, widen, increase, add to, or in any manner change the structure of this right-of-way, any required relocation of said lines shall be at the sole expense of owner.

All work on the county right-of-way shall be performed in accordance with the county instructions. The installations shall not damage any part of the road and adequate provisions must be made to cause minimum inconvenience to traffic and adjacent owners. Special specifications for placing this line are as follows:

1. All lines are to be installed a minimum of 36 inches below the flow line of the adjacent drainage or barrow ditch.
2. All excavation within the right-of-way and not under surfacing shall be backfilled by tamping in 6 inch horizontal layers. All surplus material shall be removed from the right-of-way and the excavation finished flush with surrounding natural ground.
3. Lines crossing under surfaced roads and under surfacing cross roads within the right-of-way shall be placed by boring. Boring shall extend from crown line to crown line. Gravity from sewer lines under roadways shall be cast iron pipe.
4. All lines, where practicable, shall be located to cross roadbed at approximately right angles thereto. No lines are to be installed under or within 50 feet of either end of any bridge. No lines shall be placed in any culvert or within 10 feet of the closest point of same.

5. Parallel line will be installed as near the right-of-way lines as is possible and no parallel line will be installed in the roadbed or between the drainage ditch and the roadbed without special permission of the Panola County Commissioners' Court.
6. Operations along roadbeds shall be performed in such manner that all excavated material be kept off the pavement at all times, as well as all operating equipment and materials. No equipment or installation procedures will be used which will damage any road surface or structures. The cost of any repairs to road surface, roadbed, structures or other right-of-way features as a direct result of this installation will be borne by the owner of this line.
7. Barricades, warning signs, lights, and flag man(men) when necessary shall be provided by the contractor or owner. One-half (1/2) of the traveled portion of the road must be open at all times.

Approved.

  
COUNTY JUDGE

## COMMISSIONERS:

Precinct #1 Ronnie LaGrone  
Precinct #2 Doug Cotton  
Precinct #3 Hermon E. Reed, Jr.  
Precinct #4 Dale LaGrone

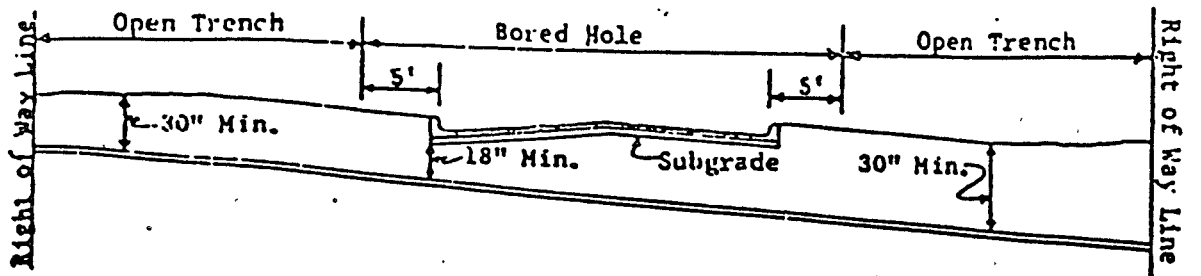
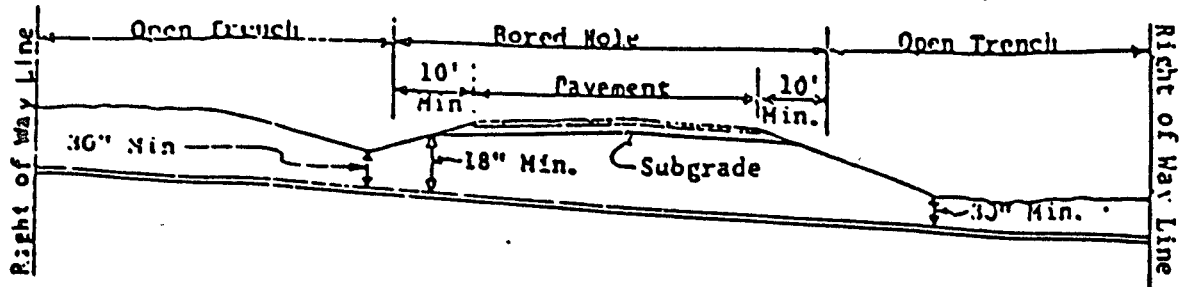

PIPE LINE CROSSING

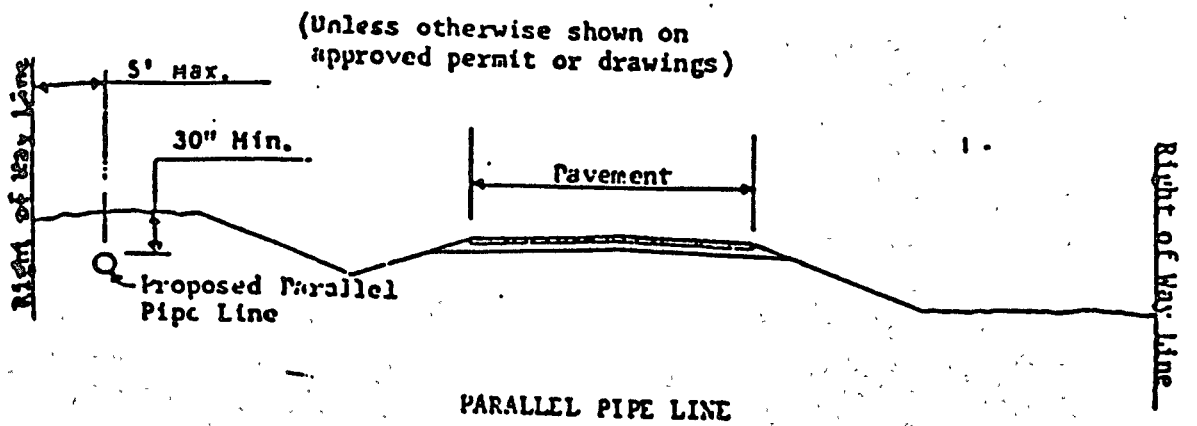

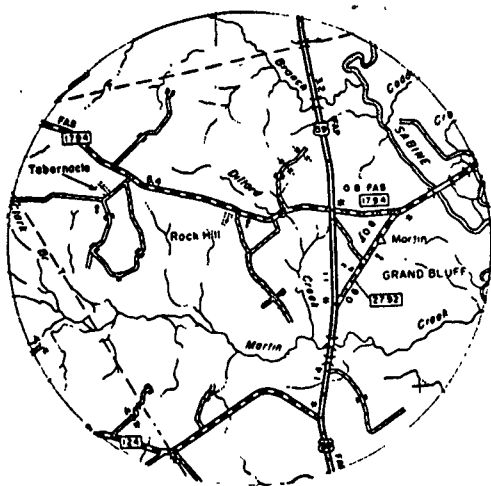
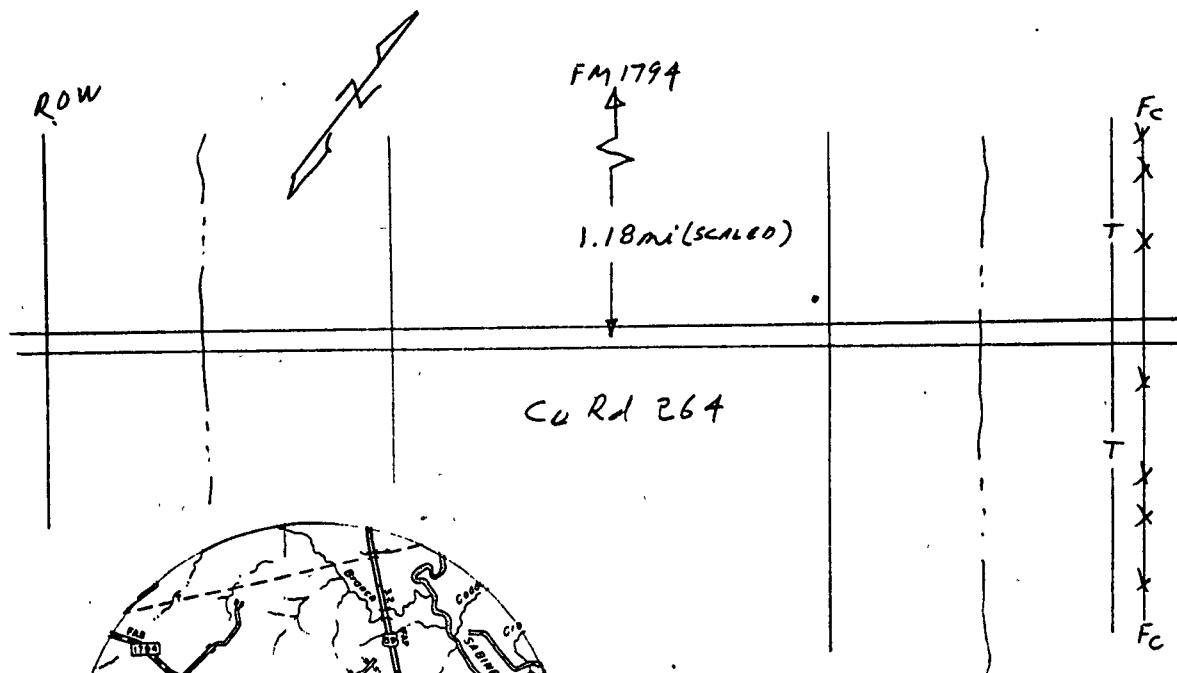
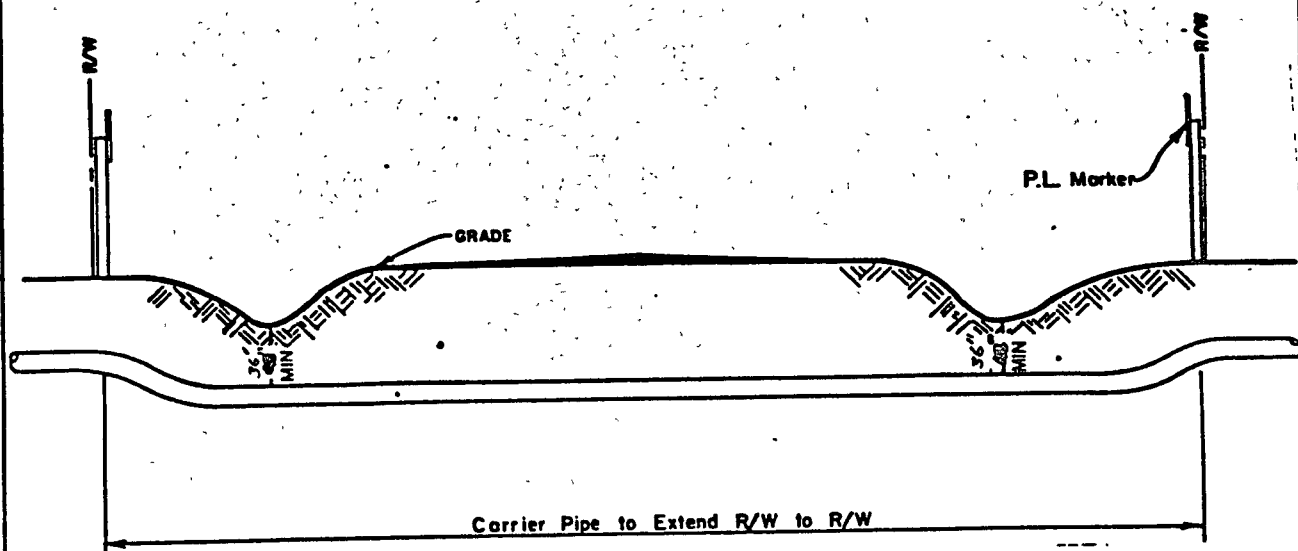

VICINITY 1 1/2 mi

LOCATION	
STATE: TEXAS	
COUNTY: PANOLA	
SURVEY: A. DUBOISE SR A-159	
PIPE DATA	
SIZE: 3 1/2" O.D.	WALL: .216"
GRADE: API 5LX-42	TYPE: STEEL
MINIMUM YIELD: 42,000 PSI	
MAX. OPERATING PRESSURE: 1000 PSI	
DRAWN BY: TCM	DATE: 03-04-05

## Donation

Date 5-7-05The undersigned has secured a contribution from Janson (Museum) to Panola

County for use in the Panola County Road and Bridge Fund. This contribution consists of:

\$ \_\_\_\_\_ and/or

material of the following type and amount 62' x 12' x 5' 3" / 62' x 12' x 5' 3"

This donation is to be used as needed by the Panola County Road and Bridge Department to improve Panola County road number 316, or if no road is indicated, then it is to be used to improve any Panola County road as seen fit by the Department. This donation must be accepted by the Panola County Commissioners' Court according to Local Govt. Code sec. 81.032 and Transportation Code sec. 252.214 and any money will be held by the Panola County Treasurer pending approval of deposit in the Road and Bridge Fund. Any material will not be used prior to the approval of the Court.

I acknowledge that this is intended as a donation and that no person or corporation has been promised any other benefit because of the donation, nor have been induced or coerced in any way by any official or employee of Panola County. I further certify that this donation was given freely and voluntarily.

Herman E. Leedy - Commissioner, Precinct# 3

Sworn and subscribed to this 7th day of March, 2004

Kathy Brown, Notary Public, State of Texas, My commission expires 01-03-2007

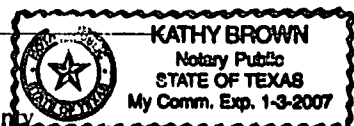

(Panola County Commissioners' Court use only)

This item was accepted / ~~disapproved~~ (strike one) at a meeting of the Panola County Commissioners' Court on this 14th day of March, 2004

County Judge David L. Anderson

PANOLA COUNTY  
2005  
BUDGET AMENDMENT #4

## GENERAL FUND

## Additional Revenues:

Cash Balance - Beginning of Year  
Total Revenues19,10019,100

## Additional &amp; Revised Expenditures:

Miscellaneous & Non-Departmental  
Computer Services & Supplies  
Insurance/Liab., Fire, ETC.  
Total15,0009,000

24,000

## Treasurer

Professional Services  
Total(6,000)

(6,000)

## Veterans Services

Capital Outlay - Furniture & Equipment  
Total1,100

1,100

Grand Total General Fund

19,100

## ROAD &amp; BRIDGE FUND

## Additional Revenues:

Cash balance - Beginning of Year  
Total Revenues3,0003,000

## Additional Expenditures:

Liability & Other Insurance  
Total Expenditures3,000

3,000

Grand Total Road &amp; Bridge Fund

3,000



PANOLA COUNTY  
2005  
BUDGET AMENDMENT #4

VOL. 49 PAGE 33

**ROCK HILL WATER SUPPLY CORP.**

**Revenues:**

Federal Grant	221,262	
Total Revenues		<u>221,262</u>

**Expenditures:**

Engineering & Architectural Service	23,800
Water Facilities	170,122
Water Services	4,840
General Administration	17,500
Acquisitions	<u>5,000</u>
Total Expenditures	221,262

**Grand Total Rock Hill Water Supply Corp.**

221,262

**123rd Judicial District Adult Drug Court Project Fund  
For Fiscal Year Ending August 31, 2005**

**Revenues:**

State Criminal Justice Division Grant	(3,600)	
Total Revenues		<u>(3,600)</u>

**Revised Expenditures:**

**Drug Court Program**

Supervision Officers 2 @ 8 mos.	2,500
Chemical Dependency Counselors 2 @ 8 mos.	(18,500)
Qualified Credentialed Counselor (QCC) - Shelby County	21,000
Surveillance Officer 1 @ 8 mos.	1,000
Law Enforcement - Prosecutor Investigators 2 @ 8 mos.	(5,100)
Court Coordinators 2 @ 8 mos.	(1,180)
Retirement & Death Benefit	(34)
Social Security	(12)
Group Medical Insurance	328
Unemployment	(2)
Postage	300
Vehicle Maintenance	4,600
Fuel	(4,600)
Fiscal Service Fee	(3,600)
Office/Computer Supplies	(4,800)
Personal Computer	<u>4,500</u>
Total Expenditures	(3,600)

**Grand Total Drug Court Fund**

(3,600)

PANOLA COUNTY  
2005  
BUDGET AMENDMENT #4

We hereby amend the Panola County Budget for the Fiscal Year 2005 as set forth above according to the procedures outlined under Vernons Texas Codes Annotated Local Government Code, Chapter 111, Subchapter A Section 111.010. The 2005 Panola County Budget is hereby so amended and we find and declare that a grave emergency and public necessity exists to meet unusual and unforeseen conditions which could not, by reasonably diligent thought and attention, have been included in the original 2005 budget as adopted. A copy of this Order is to be filed with the County Clerk and Attached to the Budget originally adopted for 2005.

Signed on this 14 day of March, 2005.

  
County Judge

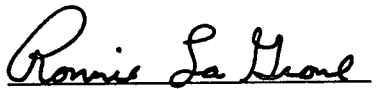
  
Commissioner Precinct # 1

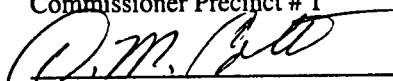
  
Commissioner Precinct # 2

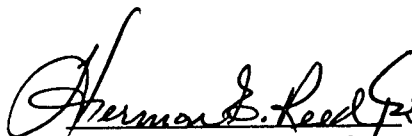
  
Commissioner Precinct # 3

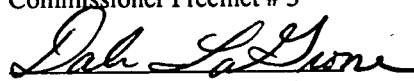
  
Commissioner Precinct # 4

Passed and approved by the Commissioners Court of Panola County on the 14<sup>th</sup> day of March, 2005 as the same appears on file in the office of the County Clerk of Panola County.

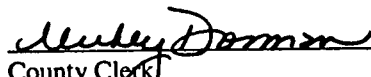
  
County Clerk

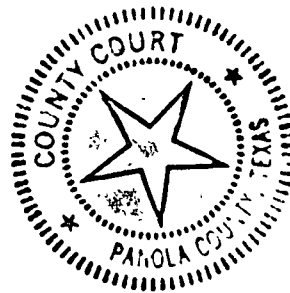

APPROVED  
03-14-05PANOLA COUNTY OFFICIAL/EMPLOYEE  
REQUEST FOR ATTENDANCE AT A CONFERENCE*David L. Anderson*  
David L. Anderson,  
County Judge

VOL. 49 PAGE 35

NAME: Vanessa Chestnut  
POSITION: IHC Co-ordinator  
DEPARTMENT: \_\_\_\_\_  
DATE: 3-1-05CONFERENCE: IHC Advisory Conference  
LOCATION: Galveston, TX  
DATES: April 27 - 28th 2005NUMBER OF DAYS OUT OF OFFICE FOR THIS CONFERENCE: 4Does the conference meet your education requirements for the year? NoIf not, how much of your requirements will be met by this conference?  
\_\_\_\_\_

How many days have you been away from your job this year for conferences, not counting this conference? \_\_\_\_\_

Do you have sufficient funds in your budget for this conference? \_\_\_\_\_

Write a short statement explaining the public purpose that will be met by your attendance at this conference: (continue on the back if necessary.)  
\_\_\_\_\_  
\_\_\_\_\_  
\_\_\_\_\_  
\_\_\_\_\_

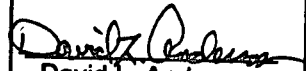
**PANOLA COUNTY OFFICIAL/EMPLOYEE  
REQUEST FOR ATTENDANCE  
AT A CONFERENCE****APPROVED**  
03-14-05  
David L. Anderson,  
County Judge

NAME:

ED BRANDO

POSITION:

EMC

DEPARTMENT:

EMERGENCY MANAGEMENT

DATE:

3/7/05

CONFERENCE:

TEXAS EMERGENCY MANAGEMENT CONF.

LOCATION:

WACO TX.

DATES:

3/20/05 to 3/24/05

NUMBER OF DAYS OUT OF OFFICE FOR THIS CONFERENCE:

4Does the conference meet your educational requirements for the year? SOMEIf not, how much of your requirements will be met by this conference? NIMSHow much of your requirements have been met already, not counting this  
conference? N/AHow many days have you been away from your job this year for conferences,  
not counting this conference? ONEDo you have sufficient funds in your budget for this conference? YESWrite a short statement explaining the public purpose that will be met by  
your attendance at this conference: (continue on the back if necessary.)

THIS IS THE YEARLY EMERGENCY MANAGEMENT  
CONFERENCE. THIS YEAR I WILL BE TAKING THE  
NATIONAL INCIDENT MANAGEMENT SYSTEM CLASS  
WHICH IS REQUIRED.

PANOLA COUNTY OFFICIAL/EMPLOYEE  
REQUEST FOR ATTENDANCE AT A CONFERENCE

APPROVED

03-14-05

*David L. Anderson*  
David L. Anderson,  
County Judge

NAME: Mickey Dorman  
POSITION: County Clerk  
DEPARTMENT: County Clerk  
DATE: 3-31-05

CONFERENCE: Region VI Texas Co. Dist Clerk's Ass'n

LOCATION: Palatine Tx

DATES: March 31, 2004 March 31, 2005

NUMBER OF DAYS OUT OF OFFICE FOR THIS CONFERENCE: 1

Does the conference meet your educational requirements for the year? no

If not, how much of your requirements will be met by this conference? 3-4 hrs

How much of your requirements have been met already, not counting this conference?

16 hrs

How many days have you been away from your job this year for conferences, not counting this conference? 4

Do you have sufficient funds in your budget for this conference? yes

Write a short statement explaining the public purpose that will be met by your attendance at this conference: (continue on the back if necessary.)

I need these continuing education hours.

VOL.

49 PAGE

38

**PANOLA COUNTY OFFICIAL/EMPLOYEE  
REQUEST FOR ATTENDANCE  
AT A CONFERENCE**

**APPROVED**  
03-14-05

*David L. Anderson*  
David L. Anderson,  
County Judge

**NAME:**

*Sandra King*

**POSITION:**

*District Clerk*

**DEPARTMENT:**

*District Clerk 3-31-05 + 4-26-2005*

**DATE:**

*3-10-05*

**CONFERENCE:**

*UT Law School + Area Meeting*

**LOCATION:**

*Austin + Palestine*

**DATES:**

*4-27-05 to 4-29-05*  
*3-31-05*

**NUMBER OF DAYS OUT OF OFFICE FOR THIS CONFERENCE:** \_\_\_\_\_

**Does the conference meet your educational requirements for the year?** *yes*

**If not, how much of your requirements will be met by this conference?** \_\_\_\_\_

**How much of your requirements have been met already, not counting this conference?** *12 hrs*

**How many days have you been away from your job this year for conferences, not counting this conference?** \_\_\_\_\_

**Do you have sufficient funds in your budget for this conference?** \_\_\_\_\_

**Write a short statement explaining the public purpose that will be met by your attendance at this conference: (continue on the back if necessary.)**

*See attached*

VOL.

49 PAGE

39

# ACTION

# ITEMS

Panola County

11 Mar 2005

THE SOFTWARE GROUP, INC.

## ACCOUNTS PAYABLE SYSTEM

03:41:56pm

Open Invoices thru 03/14/05

PAGE 1

Gross Amount. Req. Req. Discount Req. Req. Net Amt.....

\* Due 3843-33RD ANNUAL TREASURERS' \$165.00 \$0.00 \$ 165.00

\* Due 3587-A T &amp; T WIRELESS CONST. \$34.99 \$0.00 \$ 34.99

\* Due 3851-A T &amp; T WIRELESS CTHS.SEC\$26.33 \$0.00 \$ 26.33

\* Due 3588-A T &amp; T WIRELESS DPS \$80.50 \$0.00 \$ 80.50

\* Due 3400-A T &amp; T WIRELESS SO \$638.79 \$0.00 \$ 638.79

\* Due 3591-ABC AUTO PARTS - R&amp;B \$1350.60 \$0.00 \$ 1350.60

\* Due 1475-ACE HARDWARE OF EAST TEXA\$63.41 \$0.00 \$ 63.41

\* Due 1301-ADAMS OIL COMPANY \$11946.30 \$0.00 \$ 11946.30

\* Due 3464-AMERICAN ELECTRIC POWER \$111.02 \$0.00 \$ 111.02

\* Due 3427-AMERICAN ELECTRIC POWER\$1361.65 \$0.00 \$ 1361.65

\* Due 3471-AMERICAN FIBER TECHNOLOG\$427.34 \$0.00 \$ 427.34

\* Due 229-ANDERSON TRACTOR SALES \$12662.30 \$0.00 \$ 12662.30

\* Due 2833-AUTO EXPRESS LUBE \$142.87 \$0.00 \$ 142.87



Penola County  
THE SOFTWARE GROUP, INC.

ACCOUNTS PAYABLE SYSTEM  
Open Invoices thru 03/14/05

11 Mar 2005

PAGE 2

	Gross Amount.	Req.	Req.	Discount	Req.	Req.	Net Amt.....
* Due 1635-BASKIN'S MARSHALL	\$393.72			\$0.00			\$ 393.72
* Due 562-BAXTER SALES CO INC.	\$1795.88			\$0.00			\$ 1795.88
* Due 3218-BEALLS	\$22.80			\$0.00			\$ 22.80
* Due 225-BEARING SERVICE & SUPPLY, I	\$8.06			\$0.00			\$ 8.06
* Due 230-BOB BARKER COMPANY INC	\$62.76			\$0.00			\$ 62.76
* Due 524-BOBBY J. PHILLIPS	\$250.00			\$0.00			\$ 250.00
* Due 738-BRAC'S STEAKHOUSE	\$275.06			\$0.00			\$ 275.06
* Due 2679-C & S TECHNICAL SERVICES	\$170.00			\$0.00			\$ 170.00
* Due 38-C.C.I. INC	\$30.00			\$0.00			\$ 30.00
* Due 6-CAIN HARDWARE AND LUMBER CO	\$177.64			\$0.00			\$ 177.64
* Due 209-CAR-TEX TRAILER COMPAN, I	\$511.00			\$0.00			\$ 511.00
* Due 124-CARTHAGE AG & VET SUPPLY	\$7.95			\$0.00			\$ 7.95
* Due 731-CARTHAGE AWARDS	\$30.00			\$0.00			\$ 30.00

Panola County  
THE SOFTWARE GROUP, INC.ACCOUNTS PAYABLE SYSTEM  
Open Invoices thru 03/14/05

11 Mar 2005

PAGE 3

Gross Amount Req. Req. Discount Req. Req. Net Amt.....

\* Due 2560-CARTHAGE DISCOUNT TIRE &amp; \$84.00 \$0.00 \$ 84.00

\* Due 8-CARTHAGE MACHINE AND WELDING \$495.00 \$0.00 \$ 495.00

\* Due 95-CARTHAGE OFFICE SUPPLY, I \$1030.24 \$0.00 \$ 1030.24

\* Due 3434-CARTHAGE TRACTOR &amp; EQUIP \$342.45 \$0.00 \$ 342.45

\* Due 621-CENTER MOTOR COMPANY \$150.38 \$0.00 \$ 150.38

\* Due 63-CENTERPOINT ENERGY \$577.50 \$0.00 \$ 577.50

\* Due 3506-CHAD GREGORY \$74.93 \$0.00 \$ 74.93

\* Due 442-CHARLES BAILEY \$25.00 \$0.00 \$ 25.00

\* Due 42-CHEROKEE COUNTY \$325.00 \$0.00 \$ 325.00

\* Due 37-CITY OF CARTHAGE \$24032.50 \$0.00 \$ 24032.50

\* Due 1139-CITY OF CARTHAGE WATER \$933.65 P E \$0.00 \$ 933.65

\* Due 3853-CLASSIC CHEVROLET BEAU \$22148.00 \$0.00 \$ 22148.00

\* Due 3639-COMMERCIAL ELECTRONICS \$2515.00 \$0.00 \$ 2515.00

\* Due 256-COMLEY LOTT NICHOLS \$95.52 \$0.00 \$ 95.52

Panola County  
THE SOFTWARE GROUP, INC.ACCOUNTS PAYABLE SYSTEM  
Open Invoices thru 03/14/05

11 Mar 2005

PAGE 4

Gross Amount. Req. Req. Discount Req. Req. Net Amt.....

* Due 195-COREY BANKHEAD	\$500.00		\$0.00		\$ 500.00
* Due 3338-COUNSELING & PSYCHOLOGIC	\$400.00	E	TEXA	\$0.00	\$ 400.00
* Due 2769-COX COMMUNICATIONS INC	\$55.54			\$0.00	\$ 55.54
* Due 28-CRAIG MILAN ELECTRIC	\$275.00			\$0.00	\$ 275.00
* Due 1376-CRAWFORD DUANE PARKER I	\$1150.00			\$0.00	\$ 1150.00
* Due 100-CVS	\$153.68			\$0.00	\$ 153.68
* Due 43-D & C CLEANING CONTRACTOR	\$3960.00			\$0.00	\$ 3960.00
* Due 526-DAVID JETER	\$425.12			\$0.00	\$ 425.12
* Due 3536-DC TEXAS	\$32.90			\$0.00	\$ 32.90
* Due 1326-DECATUR ELECTRONICS, IN	\$1640.00			\$0.00	\$ 1640.00
* Due 1470-DELL MARKETING L.P.	\$1070.92			\$0.00	\$ 1070.92
* Due 2574-DOUG COTTON	\$53.60			\$0.00	\$ 53.60
* Due 2998-EAST TEXAS COPY SYSTEMS	\$741.00			\$0.00	\$ 741.00

Panola County  
THE SOFTWARE GROUP, INC.ACCOUNTS PAYABLE SYSTEM  
Open Invoices thru 03/14/05

11 Mar 2005

PAGE 5

	Gross Amount.	Req.	Req.	Discount	Req.	Req.	Net Amt.....
* Due 3470-ED BRANDO	\$289.71			\$0.00			\$ 289.71
* Due 3829-EDWARD WILLIAMS	\$60.00			\$0.00			\$ 60.00
* Due 3826-ETOX	\$130.45			\$0.00			\$ 130.45
* Due 93-EXCEL FORD LINCOLN MERCURY	\$477.18			\$0.00			\$ 477.18
* Due 127-EXXONMOBIL	\$129.59			\$0.00			\$ 129.59
* Due 3555-FEDEX	\$40.56			\$0.00			\$ 40.56
* Due 14-FIRMEN'S OFFICE CITY	\$648.97			\$0.00			\$ 648.97
* Due 1161-FLORENCE SIMS	\$25.00			\$0.00			\$ 25.00
* Due 53-FUTURE EQUIPMENT CO INC	\$37500.00			\$0.00			\$ 37500.00
* Due 320-GALL'S INC	\$221.97			\$0.00			\$ 221.97
* Due 3831-GARY & ANGELA GRINN	\$45.00			\$0.00			\$ 45.00
* Due 2850-HARRISON COUNTY JUVENIL	\$1140.00			\$0.00			\$ 1140.00
* Due 187-HART INTERCIVIC	\$458.58			\$0.00			\$ 458.58

Panola County  
THE SOFTWARE GROUP, INC.

ACCOUNTS PAYABLE SYSTEM  
Open Invoices thru 03/14/05

11 Mar 2005

PAGE 6

	Gross Amount.	Req.	Req.	Discount	Req.	Req.	Net Amt.....
* Due 285-HAYES-MILLER ROOFING INC	\$411.44			\$0.00			\$ 411.44
* Due 3013-HERNON E. REED, JR	\$701.70			\$0.00			\$ 701.70
* Due 370-HIGH POINT COMMUNICATIONS	\$65.84			\$0.00			\$ 65.84
* Due 2651-HIGHWAY 59 WRECKER & TR	\$3695.58	C		\$0.00			\$ 3695.58
* Due 3255-HOLT COMPANY OF TEXAS	\$506.99			\$0.00			\$ 506.99
* Due 3846-HYDROCHEN INSUTRIAL SER	\$625.00			\$0.00			\$ 625.00
* Due 1000-IKON OFFICE SOLUTIONS	\$131.42			\$0.00			\$ 131.42
* Due 3740-INTERSTATE BRANDS CORP.	\$399.68			\$0.00			\$ 399.68
* Due 930-J & L GEO SYSTEMS	\$312.00			\$0.00			\$ 312.00
* Due 2806-JAMES KEITH KNIGHT	\$25.00			\$0.00			\$ 25.00
* Due 1055-JEFF SCARBOROUGH	\$87.49			\$0.00			\$ 87.49
* Due 716-JINERSON FUNERAL HOME	\$417.00			\$0.00			\$ 417.00
* Due 906-JOE WINS	\$6.92			\$0.00			\$ 6.92
* Due 2520-JOHN F. NIELSEN, M.D.	\$150.00			\$0.00			\$ 150.00

Panola County  
THE SOFTWARE GROUP, INC.

ACCOUNTS PAYABLE SYSTEM  
Open Invoices thru 03/14/05

11 Mar 2005

PAGE 7

Gross Amount. Req. Req. Discount Req. Req. Net Amt.....

* Due 5-KEN TURNER PHARMACY	\$963.66		\$0.00		\$ 963.66
* Due 84-KIRBY RESTAURANT SUPPLY	\$291.50		\$0.00		\$ 291.50
* Due 3786-KRAUSE CHILDREN'S RESIDEN	\$45.00		\$0.00		\$ 45.00
* Due 3121-L. D. RESOURCES	\$715.49		\$0.00		\$ 715.49
* Due 3074-L.C. & J. CLAYTON LAGRONE	\$50.00		\$0.00		\$ 50.00
* Due 181-LAGRONE AIR CONDITIONING	\$847.38	C	\$0.00		\$ 847.38
* Due 188-LEGAL DIRECTORIES	\$76.50		\$0.00		\$ 76.50
* Due 3848-LEW DUNN	\$350.00		\$0.00		\$ 350.00
* Due 443-LINNER PERKINS	\$98.00		\$0.00		\$ 98.00
* Due 3830-LINDA CRAWFORD	\$30.00		\$0.00		\$ 30.00
* Due 1240-N.G. CLEANERS	\$195.49		\$0.00		\$ 195.49
* Due 3739-NARV GOLDEN DISCOUNT SAL	\$287.50		\$0.00		\$ 287.50
* Due 425-NORRIS SANFORD JR.	\$900.00		\$0.00		\$ 900.00

Panola County  
THE SOFTWARE GROUP, INC.ACCOUNTS PAYABLE SYSTEM  
Open Invoices thru 03/14/05

11 Mar 2005

PAGE 8

	Gross Amount.	Req.	Req.	Discount	Req.	Req.	Net Amt.....
* Due 3645-NARDIS, INC	\$568.60			\$0.00			\$ 568.60
* Due 455-NORMAN COMMUNICATIONS	\$449.60			\$0.00			\$ 449.60
* Due 3238-NORTRAX	\$776.76			\$0.00			\$ 776.76
* Due 3030-O'REILLY AUTO PARTS	\$82.96			\$0.00			\$ 82.96
* Due 3596-O'REILLY AUTO PARTS-S.O.	\$111.97			\$0.00			\$ 111.97
* Due 3927-OFFICE DEPOT CARD PLAN	\$175.00			\$0.00			\$ 175.00
* Due 3202-OLNSTED-KIRK PAPER CONPA	\$345.45			\$0.00			\$ 345.45
* Due 3316-PANOLA WORTHINGTON	\$750.00			\$0.00			\$ 750.00
* Due 3193-PANOLA COUNTY CHILD PROT	\$146.09	R		\$0.00			\$ 146.09
* Due 512-PANOLA COUNTY GENERAL FU	\$1080.25			\$0.00			\$ 1080.25
* Due 3474-PANOLA COUNTY PLUMBING	\$452.50			\$0.00			\$ 452.50
* Due 2693-PANOLA COUNTY SPECIAL FEES	\$4.13			\$0.00			\$ 4.13
* Due 737-PANOLA POST/WATCHMAN	\$190.65			\$0.00			\$ 190.65

Panola County  
THE SOFTWARE GROUP, INC.ACCOUNTS PAYABLE SYSTEM  
Open Invoices thru 03/14/05

11 Mar 2005

PAGE 9

Gross Amount. Req. Req. Discount Req. Req. Net Amt.....

* Due 3269-PATRICE SAVAGE	\$1750.00		\$0.00		\$ 1750.00
* Due 3728-PATRICK & RONDA MCENRY	\$45.00		\$0.00		45.00
* Due 1323-PAUL BANNER	\$78.11		\$0.00		78.11
* Due 103-PEGUES-HURST MOTOR CO.	\$496.60		\$0.00		496.60
* Due 69-PITNEY BOWES	\$586.00		\$0.00		586.00
* Due 3498-PNI COMPUTER SUPPLIES	\$514.30		\$0.00		514.30
* Due 412-QUILL CORPORATION	\$815.67		\$0.00		815.67
* Due 310-RADIO SHACK	\$207.91		\$0.00		207.91
* Due 3847-REEDER-DAVIS FUNERAL HOME	\$181.25		\$0.00		181.25
* Due 525-RICK MCPHERSON	\$250.00		\$0.00		250.00
* Due 111-ROBINSON & WILLIAMS	\$1200.00		\$0.00		1200.00
* Due 3845-ROLLINS FARM EQUIPMENT	\$10800.00		\$0.00		10800.00
* Due 3613-RONNETTE COOKE	\$20.00		\$0.00		20.00
* Due 3296-S. D. TWOMEY	\$25.00		\$0.00		25.00



Panola County  
THE SOFTWARE GROUP, INC.

ACCOUNTS PAYABLE SYSTEM  
Open Invoices thru 03/14/05

11 Mar 2005

PAGE 10

Gross Amount. Req. Req. Discount Req. Req. Net Amt.....

* Due 189-SBC	\$32.10			\$0.00		\$ 32.10
* Due 2142-SEARS COMMERCIAL ONE	\$39.88			\$0.00		\$ 39.88
* Due 3028-SENSE OF SOUND	\$211.24			\$0.00		\$ 211.24
* Due 1690-SHREVEPORT COMMUNICATION	\$242.20			\$0.00		\$ 242.20
* Due 3027-SIGN EXPRESS	\$75.00			\$0.00		\$ 75.00
* Due 3050-SOUTHERN FOLGER DETENTI	\$1420.00			\$0.00		\$ 1420.00
* Due 3666-ST PAUL TRAVELERS	\$301658.00			\$0.00		\$ 301658.00
* Due 2959-SUZZANE M. BLAKE ND	\$360.00			\$0.00		\$ 360.00
* Due 3844-TAC - PFIA/CIO TRAINING	\$25.00			\$0.00		\$ 25.00
* Due 3852-TAP PUBLISHING COMPANY	\$73.95			\$0.00		\$ 73.95
* Due 106-TEECO SAFETY, INC.	\$464.61			\$0.00		\$ 464.61
* Due 2960-TERRY W. BLAKE PA-C	\$295.00			\$0.00		\$ 295.00
* Due 1098-TEXAS FILTER SERVICE INC	\$265.00			\$0.00		\$ 265.00

Panola County  
THE SOFTWARE GROUP, INC.ACCOUNTS PAYABLE SYSTEM  
Open Invoices thru 03/14/05

11 Mar 2005

PAGE 11

	Gross Amount.	Req.	Req.	Discount	Req.	Req.	Net Amt.....
* Due 3009-TEXAS PARKS & WILDLIFE	\$215.05			\$0.00			\$ 215.05
* Due 3002-TEXAS PARKS & WILDLIFE	\$415.65			\$0.00			\$ 415.65
* Due 3399-TEXAS TRAUMA & EMERGENCY	\$172.00			\$0.00			\$ 172.00
* Due 2500-TEXAS WILDLIFE DAMAGE	\$1800.00			\$0.00			\$ 1800.00
* Due 231-THE PATTERSON INSURANCE	\$129.00			\$0.00			\$ 129.00
* Due 1-TOLEDO AUTOMOTIVE	\$5711.59			\$0.00			\$ 5711.59
* Due 854-TRACY ANDERSON	\$38.19			\$0.00			\$ 38.19
* Due 3849-TUFF COAT	\$75.00			\$0.00			\$ 75.00
* Due 101-TWIN STATE TRUCKS INC	\$1537.14			\$0.00			\$ 1537.14
* Due 1896-UNIFIRST	\$567.18			\$0.00			\$ 567.18
* Due 3600-UPS	\$29.02			\$0.00			\$ 29.02
* Due 1650-USPS DISBURSING OFFICER	\$235.00			\$0.00			\$ 235.00
* Due 91-VIKING OFFICE PRODUCTS	\$159.83			\$0.00			\$ 159.83

Panola County  
THE SOFTWARE GROUP, INC.ACCOUNTS PAYABLE SYSTEM  
Open Invoices thru 03/14/05

11 Mar 2005

PAGE 12

	Gross Amount.	Req.	Req.	Discount	Req.	Req.	Net Amt.....
* Due 2971-WALMART COMMUNITY SO	\$57.21			\$0.00			\$ 57.21
* Due 2533-WEST GROUP	\$1005.24			\$0.00			\$ 1005.24
* Due 68-WILLIAMS TRUCK PARTS	\$2478.53			\$0.00			\$ 2478.53
* Due 64-XEROX CORPORATION	\$863.60			\$0.00			\$ 863.60
Totals	\$492349.58			\$0.00			\$ 492349.58

377 records listed.

**PERSONNEL CHANGE REQUEST**Name: KEVIN BURMISTARDepartment: R&BPosition: SENIOR IACNew Position  
(if applicable): \_\_\_\_\_

Current wage or salary

12.29

New wage or salary

3/14/05

Effective date of change

[Signature]  
Elected Official/Department Head  
Signature

3-14-05  
Date Signed

## PERSONNEL CHANGE REQUEST

Name: DANNY PORTERDepartment: R & BPosition: TRUCK DRIVERNew Position  
(if applicable): \_\_\_\_\_

Current wage or salary

\$ 9.34  
xx

New wage or salary

\$ 9.61  
xx

Effective date of change

3/15/05*Dan LaLonde*  
Elected Official/Department Head  
Signature3-14-05  
Date Signed