

FILED FOR RECORD
IN MY OFFICE

AT 2:40 O'CLOCK P M

APR 21 2005

MICKEY DORMAN
COUNTY CLERK, PANOLA COUNTY, TEXAS

BY *Mickey Dorman* DEPUTY

**MEETING OF COMMISSIONERS' COURT
OF PANOLA COUNTY**

TO WHOM IT MAY CONCERN:

PURSUANT TO THE TEXAS OPEN MEETINGS ACT, NOTICE IS HEREBY GIVEN THAT A SPECIAL MEETING OF THE COMMISSIONERS' COURT OF PANOLA COUNTY, TEXAS WILL BE HELD ON THE 25TH DAY OF APRIL, 2005, IN THE COMMISSIONERS' COURTROOM IN THE PANOLA COUNTY COURTHOUSE IN CARTHAGE, TEXAS AT 9:00 O'CLOCK A.M. AT WHICH MEETING THE FOLLOWING SUBJECTS WILL BE DISCUSSED AND THE FOLLOWING MATTERS ACTED UPON:

OPEN MEETING:

1. **CITIZEN COMMENTS:** This is for citizens to comment on any subject not on the current agenda concerning county business. Members of the Court may answer direct questions, but any action from this item must be scheduled on a future agenda.
2. **COMMISSIONERS' REPORT:** These are for informational purposes only. Any action that needs to be taken on the basis of these reports will be placed on a future agenda for action.
3. **COUNTY JUDGE'S REPORT:** This is for informational purposes only. Any action that needs to be taken on the basis of this report will be placed on a future agenda for action.
4. **CONSENT ITEMS:**

PERSONNEL

- a. To record the resignation of Kiesha Burchette as a Communications Officer with the Panola County Sheriff's Department effective April 15, 2005.
- b. To record the promotion of Brenda Jackson from Seasonal Communications Officer to Full Time Communications Officer for the Panola County Sheriff's Department effective April 16, 2005.

- c. To record the termination of Codey Adams as a Reserve Deputy with the Panola County Sheriff's Department effective April 15, 2005.

ROAD & BRIDGE

- a. To approve and record a request by BP America Production Co. to cross under Panola County Road #216 with a 4" line.
- b. To approve and record a request by Comstock Oil & Gas L.P. to cross under Panola County Road #241 with a 4" line.
- c. To approve and record a request by Devon to cross under Panola County Road #116 with a 4" steel line.
- d. To approve and record a request by Lacy Oil Co. to cross under Panola County Road #264 with a 4" line.
- e. To authorize the County Auditor to advertise for sealed bids for a Dump Truck to be used by the Panola County Road and Bridge Department. Bid specifications available at the Panola County Warehouse, 1120 E. Sabine, Carthage, Texas 75633 or the County Judge's Office, 110 S. Sycamore, Room 216-A, Carthage, Texas 75633. Bids to be opened at a Special Session of the Commissioners' Court scheduled for May 23, 2005.
- f. To approve and record a request by Hopewell Operating to cross under Panola County Road #3311 with a 2" pipe line.

MISCELLANEOUS

- a. To ratify and record a contract for maintenance and service of two (2) elevators between ThyssenKrupp Elevator and Panola County.
- b. To record Panola County Criminal District Attorney State Forfeiture Fund Budget Amendment for Fiscal Year 2005.
- c. To ratify and record Federal Equitable Sharing Agreement and Federal Annual Certification Report between the Federal Government, Panola County Sheriff's Department and Panola County.

REQUESTS FOR CONFERENCE ATTENDANCE

- a. To approve and record a Request for Attendance at a Conference form(s) for the following Panola County elected official(s)/employee(s): Panola County Treasurer Gloria Portman (3); and Panola County 123rd Judicial District Court Administrator Karma Roberts Ragster.
5. To approve Road & Bridge requisitions and to approve payment of current Panola County bills as presented on vouchers prepared and submitted by the County Auditor.

6. To discuss and act upon appointing Ruth Bristow to the Panola County Children's Service Board.
7. To discuss and act upon adopting Resolution #2005-08 closing a portion of Panola County Road #240 as petitioned by TXU Mining Company, LP. (Speaker: Don Montgomery)
8. To discuss and act upon approving a Purchase Agreement between The Software Group and Panola County for an AbleTerm Client Access License for the Panola County District Clerk's Office.
9. To discuss and act upon approving an increase in salary to \$11.25 per hour for Deland Wynn, Truck Driver with the Panola County Road and Bridge Department, Precinct #2, effective April 26, 2005.
10. To discuss and act upon approving an increase in salary to \$11.25 per hour for Dale Downing, Truck Driver with the Panola County Road and Bridge Department, Precinct #2, effective April 26, 2005.
11. To discuss and act upon approving an adjustment by C. Miller Drilling Co. in the price for the water well at Panola County Airport - Sharpe Field due to state regulation.
12. To discuss and act upon allowing AFLAC to offer county employees optional Cancer, Cardiovascular, Intensive Care, Personal Accident Indemnity, Short Term Disability, and Dental Insurance.
13. To declare one (1) Bomag steel double drum roller, Model #BW120AD-2, Serial #101170500599, and one (1) Sovema tractor/tiller attachment, Serial #51989 as surplus property; and to authorize the sale of said surplus property to Shelby County, Texas pursuant to Local Government Code 263.152(a)(1).
14. To approve, accept, and record a donation of \$100.00 from The Pipeline Group for new tables for the Exposition Center.
15. To discuss and act upon approving Grant Application for continued assistance through the LLEBG-Rural Drug Court Initiative for the 123rd Judicial District Drug Court for Fiscal Year ending August 31, 2006.

ADJOURNMENT

WITNESS THE HAND OF THE UNDERSIGNED CLERK ON THIS THE 21ST DAY
OF APRIL, 2005 AT 2:40 O'CLOCK P.M.



Mickey Dorman
MICKEY DORMAN, COUNTY CLERK
PANOLA COUNTY, TEXAS

By: _____, Deputy

I, MICKEY DORMAN, CLERK OF THE COMMISSIONERS' COURT OF PANOLA COUNTY, TEXAS DO HEREBY CERTIFY THAT THE ABOVE NOTICE WAS POSTED ON THE OFFICIAL BULLETIN BOARD IN THE PANOLA COUNTY COURTHOUSE IN THE CITY OF CARTHAGE, TEXAS AND IN A PUBLIC PLACE VISIBLE AT ALL TIMES ON THE 21ST DAY OF APRIL, 2005 AT 2:40 O'CLOCK P.M.

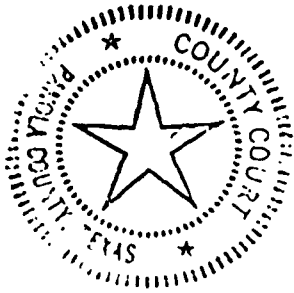

Mickey Dorman
MICKEY DORMAN, COUNTY CLERK
PANOLA COUNTY, TEXAS
By: _____, Deputy

MAY 10 2005

MICKEY DORMAN
COUNTY CLERK, PANOLA COUNTY, TEXASBY Mickey Dorman 060113

The State of Texas
County of Panola

On this the 25th day of April A.D. 2005, the Commissioners' Court of Panola County, Texas met in a Special Meeting of the Court at 9:00 o'clock a.m. in the Commissioners' Courtroom of said County with the following members of the Court present:

David L Anderson	County Judge
Ronnie LaGrone	Commissioner, Precinct #1
Douglas M. Cotton	Commissioner, Precinct #2
Hermon E. Reed, Jr.	Commissioner, Precinct #3
Dale LaGrone	Commissioner, Precinct #4

with none absent, constituting a quorum of the Court. Also attending were Mickey Dorman, County Clerk and Lee Ann Jones, Administrative Assistant to the County Judge. Attached to and made a part of these Minutes is a list of other attendees and the office or organization that each represents. The following proceedings were held at this meeting:

OPEN MEETING:

1. CITIZEN COMMENTS:

There were no comments from the citizens in attendance.

2. COMMISSIONERS' REPORTS:

Commissioner Ronnie LaGrone reported that the water well at the airport had been completed at a depth of about 300 feet. The water is still cloudy but appears to be good with no sign of iron content.

He also reported that the plans for the hot air balloon event are progressing.

Commissioner Reed reported that he had attended a water board meeting and returned with information which he had left with Judge Anderson for anyone interested to inspect. He said that public notices regarding the water issues will be posted at the library or the Courthouse.

Commissioner Cotton reported attending a meeting of TxDOT on April 12 regarding the Highway 149 project. Currently the plan is to widen the existing road instead of taking a new route as was once discussed. That would be less costly. He reported that nothing is being done to acquire the necessary property yet. That could be as much as three years in the future.

3. COUNTY JUDGE'S REPORT:

Judge Anderson reported that the first meeting of the committee to consider the possibility of a jail expansion project is scheduled for tonight.

4. CONSENT ITEMS:

PERSONNEL

- ▼ a. To record the resignation of Kiesha Burchette as a Communications Officer with the Panola County Sheriff's Department effective April 15, 2005.

- ✓ b. To record the promotion of Brenda Jackson from Seasonal Communications Officer to Full Time Communications Officer for the Panola County Sheriff's Department effective April 16, 2005.
- ✓ c. To record the termination of Codey Adams as a Reserve Deputy with the Panola County Sheriff's Department effective April 15, 2005.

ROAD & BRIDGE

- ✓ a. To approve and record a request by BP America Production Co. to cross under Panola County Road #216 with a 4" line.
- ✓ b. To approve and record a request by Comstock Oil & Gas L.P. to cross under Panola County Road #241 with a 4" line.
- ✓ c. To approve and record a request by Devon to cross under Panola County Road #116 with a 4" steel line.
- ✓ d. To approve and record a request by Lacy Oil Co. to cross under Panola County Road #264 with a 4" line.
- ✓ e. To authorize the County Auditor to advertise for sealed bids for a Dump Truck to be used by the Panola County Road and Bridge Department. Bid specifications are available at the Panola County Warehouse, 1120 E. Sabine, Carthage, Texas 75633 or the County Judge's Office, 110 S. Sycamore, Room 216-A, Carthage, Texas 75633. The bids are to be opened at a Special Session of the Commissioners' Court scheduled for May 23, 2005 at 9:00 o'clock a.m.
- ✓ f. To approve and record a request by Hopewell Operating to cross under Panola County Road #3311 with a 2" pipe line.

MISCELLANEOUS

- ✓ a. To ratify and record a contract for maintenance and service of two (2) elevators between ThyssenKrupp Elevator and Panola County.
- ✓ b. To record Panola County Criminal District Attorney State Forfeiture Fund Budget Amendment for Fiscal Year 2005.
- ✓ c. To ratify and record Federal Equitable Sharing Agreement and Federal Annual Certification Report between the Federal Government, Panola County Sheriff's Department and Panola County.

REQUESTS FOR CONFERENCE ATTENDANCE

- ✓ a. To approve Request for Attendance at a Conference form(s) for Panola County Treasurer Gloria Portman (3) and Panola County 123rd Judicial District Court Administrator Karma Roberts Ragster.

Judge Anderson noted that the time for the meeting to open the bids mentioned in Road and Bridge item e. should be 9:00 o'clock a.m. Commissioner Cotton moved and Commissioner Dale LaGrone seconded the motion to approve all the Consent Items. The motion passed unanimously.

A COPY OF EACH AMENDMENT REQUEST AND/OR BOND IS ATTACHED TO AND MADE A PART OF THE MINUTES.

- ✓ 5. Commissioner Cotton moved and Commissioner Reed seconded the motion to approve the Road & Bridge requisitions and to approve the payment of the current Panola County bills as presented on vouchers prepared and submitted by the County Auditor. The motion passed unanimously. SEE LIST OF BILLS ATTACHED.

6. After some discussion Commissioner Ronnie LaGrone moved and Commissioner Cotton seconded the motion to appoint Ruth Bristow to the Panola County Children's Service Board. The motion passed unanimously. SEE COPY OF APPOINTMENT ATTACHED.
7. After some discussion and a presentation by Mr. Don Montgomery, Commissioner Cotton moved and Commissioner Ronnie LaGrone seconded the motion to adopt Resolution #2005-08 closing a portion of Panola County Road #240 as petitioned by TXU Mining Company, LP. The motion passed unanimously. SEE COPY OF RESOLUTION ATTACHED.
8. After some discussion Commissioner Dale LaGrone moved and Commissioner Ronnie LaGrone seconded the motion to approve a Purchase Agreement between The Software Group and Panola County for an AbleTerm Client Access License for the Panola County District Clerk's Office. The motion passed unanimously. SEE COPY OF AGREEMENT ATTACHED.
9. After some discussion Commissioner Cotton moved and Commissioner Reed seconded the motion to approve an increase in salary to \$11.25 per hour for Deland Wynn, Truck Driver with the Panola County Road and Bridge Department, Precinct #2 effective April 26, 2005. The motion passed unanimously. SEE COPY OF REQUEST ATTACHED.
10. After some discussion Commissioner Cotton moved and Commissioner Dale LaGrone seconded the motion to approve an increase in salary to \$11.25 for Dale Downing, Truck Driver with the Panola County Road and Bridge Department, Precinct #2, effective April 26, 2005. The motion passed unanimously. SEE COPY OF REQUEST ATTACHED.
11. After some discussion Commissioner Dale LaGrone moved and Commissioner Ronnie LaGrone seconded the motion to approve an adjustment by C. Miller Drilling Co. in the price for the water well at Panola County Airport - Sharpe Field due to state regulation. The motion passed unanimously. SEE DOCUMENTATION ATTACHED.
12. After some discussion Commissioner Cotton moved and Commissioner Dale LaGrone seconded the motion to not allow AFLAC to offer county employees optional Cancer, Cardiovascular, Intensive Care, Personal Accident Indemnity, Short Term Disability, and Dental Insurance. The motion passed unanimously.
13. After some discussion Commissioner Dale LaGrone moved and Commissioner Cotton seconded the motion to declare one (1) Bomag steel double drum roller, Model #BW120AD-2, Serial #101170500599, and one (1) Sovema tractor/tiller attachment, Serial #51989 as surplus property; and to authorize the sale of said surplus property to Shelby County, Texas pursuant to Local Government Code 263.152(a)(1). The motion passed unanimously.
14. After some discussion Commissioner Ronnie LaGrone moved and Commissioner Reed seconded the motion to approve, accept and record a donation of \$100.00 from the The Pipeline Group for new tables for the Exposition Center. The motion passed unanimously. SEE COPY OF DONATION ATTACHED.
15. After some discussion Commissioner Cotton moved and Commissioner Ronnie LaGrone seconded the motion to approve the Grant Application for continued assistance through the LLEBG-Rural Drug Court Initiative for the 123rd Judicial District Drug Court for Fiscal Year ending August 31, 2006. The motion passed unanimously. SEE COPY OF APPLICATION ATTACHED.

Dated this the 25th day of April, 2005.

David L. Anderson
David L. Anderson, County Judge, Panola County, Texas

ATTEST:

Mickey Dorman
Mickey Dorman, County Clerk, Panola County, Texas



25 April 2005

9:00 am

Sonita Phillips
Kevin Kent
Don Montgomery
Veronica Hummadi
Ruth Skell
Ruth Bristow
Jill A
Brynn Parrott
Susie Churchill

CONSENT

ITEMS

314 W WELLINGTON
CARTHAGE, TX 75633
(903) 693-0333
FAX (903) 693-9366



JACK ELLETT
SHERIFF

PANOLA COUNTY SHERIFF'S DEPARTMENT

April 14, 2005

The Honorable David Anderson
Panola County Judge
110 S. Sycamore
Carthage, Texas 75633

Judge Anderson:

Please add the following amended request to the April 14, 2005 agenda scheduled Commissioner's meeting:

- 1) Record the resignation of Kiesha Burchette as a Communication Officer for the Panola County Sheriff's Office, effective April 15, 2005.
- 2) Record the promotion of Brenda Jackson to full time Communication Officer for the Panola County Sheriff's Office, effective April 16, 2005.

Sincerely,

A handwritten signature in cursive script, appearing to read "Jack Ellett".

Jack Ellett
Sheriff

JE/cs

CC: Sidney Burns
Gloria Portman

HONESTY - INTEGRITY - DEDICATION

314 W. WELLINGTON
CARTHAGE, TX 75633
(903) 693-0333
FAX (903) 693-9366



JACK ELLETT
SHERIFF

PANOLA COUNTY SHERIFF'S DEPARTMENT

April 15, 2005

Panola County Commissioner's Court
Panola County Courthouse

Dear Sirs:

Please record the termination of Codey Adams as a Reserve Deputy with this department.
Effective 4/15/2005.

Yours truly,

A handwritten signature in cursive script that reads "Byron McMillen".

Byron McMillen
Captain

Cc: Sidney Burns

HONESTY - INTEGRITY - DEDICATION

NOTICE OF PROPOSED INSTALLATION
PIPE AND /OR UTILITY LINES

TO: THE PANOLA COUNTY COMMISSIONERS COURT

c/o

PANOLA COUNTY ROAD & BRIDGE DEPARTMENT CARTHAGE, TEXAS

Formal notice is hereby give that:

BP America Production Co. Proposes to place a
(COMPANY NAME)

4" Line within the Right-of-Way
(PIPE SIZE)

of County Road: 216 as follows:
(NUMBER OF ROAD)

The proposed pipeline will cross under the indicated roads on the attached sheet.
Installation shall be made by boring total length of line in Panola County is 80 feet.

The location and description of the proposed line and appurtenances is more fully shown by the copies of the drawings attached to this notice. The line will be constructed and maintained on the County Right-of-Way as directed by the County Commissioners in accordance with current Panola County Specifications.

Construction of this line will begin on or after the 15th day of
April 2000: 2005

FIRM: BP America Production Co.
BY: Lynne Taylor
TITLE: Landowner Relations
ADDRESS: PO Box 9460
Longview, Tx 75608
PHONE: (903) 297-4021

APPROVAL

April 25, 2005

TO: Mr. Lynn Taylor
BP America Production Co.
P. O. Box 9460
Longview, Texas 75608

RE: CR #216

The Panola County Commissioners' Court offers no objection to the location on the right-of-way of your proposed 4" line as shown by accompanying drawings and notice except as noted below.

It is expressly understood that the County Commissioners' Court does not purpose hereby, to grant any right, claim, title or easement in or upon this county road. It is further understood that in the future should for any reason the county need to work, improve, relocate, widen, increase, add to, or in any manner change the structure of this right-of-way, any required relocation of said lines shall be at the sole expense of owner.

All work on the county right-of-way shall be performed in accordance with the county instructions. The installations shall not damage any part of the road and adequate provisions must be made to cause minimum inconvenience to traffic and adjacent owners. Special specifications for placing this line are as follows:

1. All lines are to be installed a minimum of 36 inches below the flow line of the adjacent drainage or barrow ditch.
2. All excavation within the right-of-way and not under surfacing shall be backfilled by tamping in 6 inch horizontal layers. All surplus material shall be removed from the right-of-way and the excavation finished flush with surrounding natural ground.
3. Lines crossing under surfaced roads and under surfacing cross roads within the right-of-way shall be placed by boring. Boring shall extend from crown line to crown line. Gravity from sewer lines under roadways shall be cast iron pipe.
4. All lines, where practicable, shall be located to cross roadbed at approximately right angles thereto. No lines are to be installed under or within 50 feet of either end of any bridge. No lines shall be placed in any culvert or within 10 feet of the closest point of same.

5. Parallel line will be installed as near the right-of-way lines as is possible and no parallel line will be installed in the roadbed or between the drainage ditch and the roadbed without special permission of the Panola County Commissioners' Court.
6. Operations along roadbeds shall be performed in such manner that all excavated material be kept off the pavement at all times, as well as all operating equipment and materials. No equipment or installation procedures will be used which will damage any road surface or structures. The cost of any repairs to road surface, roadbed, structures or other right-of-way features as a direct result of this installation will be borne by the owner of this line.
7. Barricades, warning signs, lights, and flag man(men) when necessary shall be provided by the contractor or owner. One-half (1/2) of the traveled portion of the road must be open at all times.

Approved: *Davis L. Anderson*
COUNTY JUDGE

COMMISSIONERS:

Precinct #1 Ronnie LaGrone
Precinct #2 Doug Cotton
Precinct #3 Hermon E. Reed, Jr.
Precinct #4 Dale LaGrone



	Figure 1 Topographic Features of the Proposed CGU 6A-12 Well Site, Access Road, and Pipeline Locations in Panola County, TX				
Brammer Engineering, Inc. Project Number: 046053 00		Date: 03/17/2005		Base Map: USGS 7.5 Minute Topographic Quadrangle Morris Chapel, TX (Provisional Ed., 1933)	
1800 HW Loop 221, Suite 300 Longview, TX 75204 Phone: (409) 277-4375 Fax: (409) 277-4375					

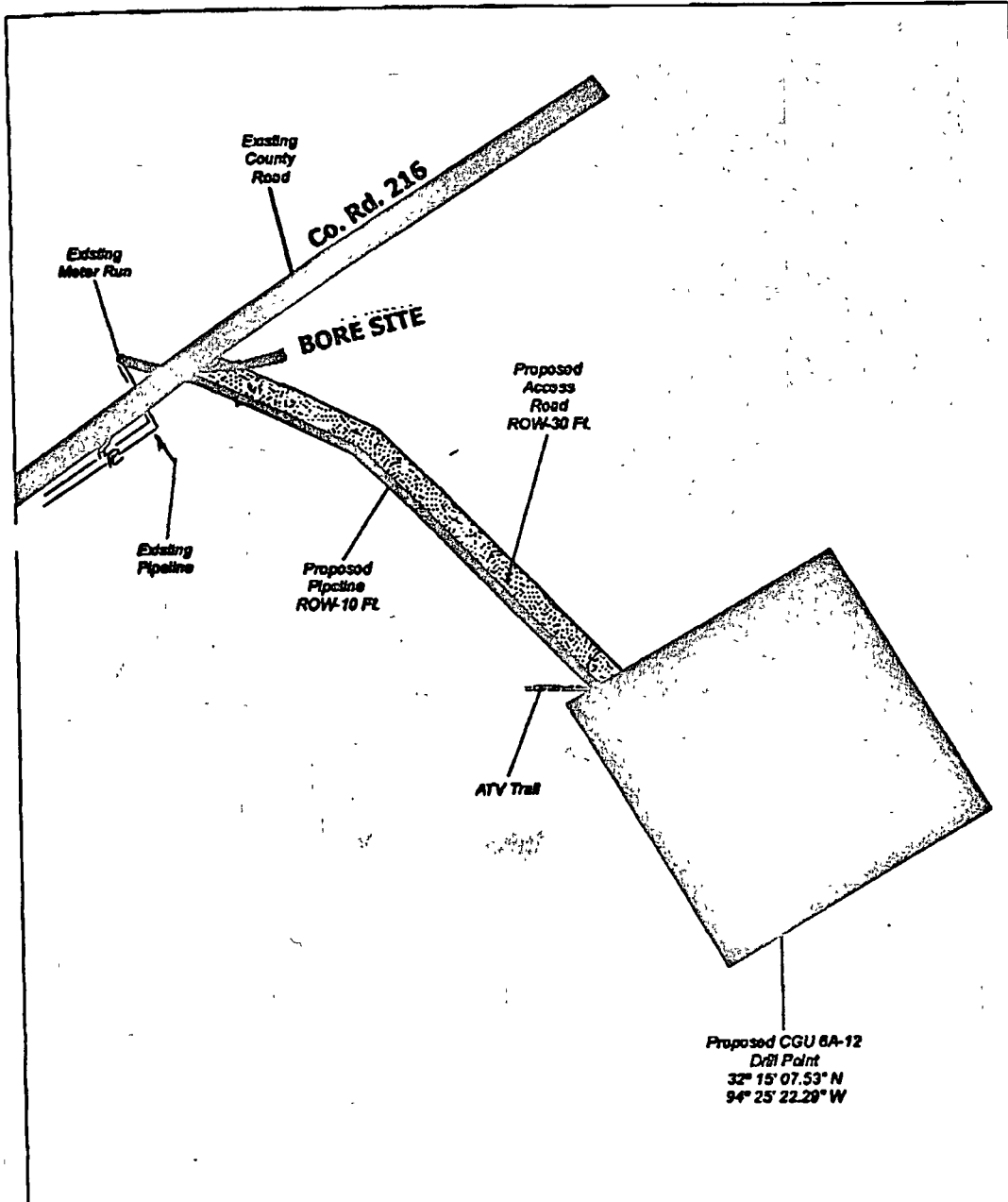

	Figure 2 Site Plan of the Proposed CGU 6A-12 Well Site, Access Road, and Pipeline Locations in Panola County, TX		
	0 75 150 300 450 600 Feet		
Brammer Engineering, Inc. Project Number: 048053.00	Date: 03/17/2005	Coordinate Sys. UTM NAD27 Zone 15	1800 NW Loop 281, Suite 303 Longview, TX 75604 Phone (903) 287-4073 Fax (903) 287-4076

NOTICE OF PROPOSED INSTALLATION
PIPELINE AND /OR UTILITY LINES

TO: THE PANOLA COUNTY COMMISSIONERS COURT

c/o

PANOLA COUNTY ROAD & BRIDGE DEPARTMENT CARTHAGE, TEXAS

Formal notice is hereby give that:

Comstock Oil & Gas, LP Proposes to place a
(COMPANY NAME)
4" Line within the Right-of-Way
(PIPE SIZE)

of County Road: 241 as follows:
(NUMBER OF ROAD)

The proposed pipeline will cross under the indicated roads on the attached sheet. Installation shall be made by boring total length of line in Panola County is 60'.

The location and description of the proposed line and appurtenances is more fully shown by the copies of the drawings attached to this notice. The line will be constructed and maintained on the County Right-of-Way as directed by the County Commissioners in accordance with current Panola County Specifications.

Construction of this line will begin on or after the 12th day of April 2005.

FIRM: Comstock Oil & Gas LP
BY: Jim Northcott
TITLE: Field Landman
ADDRESS: PO Box 281
Carthage, TX 75633
PHONE: (903) 926-0335

**SPECIAL SPECIFICATIONS
FOR PIPE LINES CROSSING IN BORED HOLES
AND PLACED PARALLEL TO COUNTY ROADS**

GENERAL NOTE: The construction of this project shall follow "The Panola County Road and Bridge Department Standard Specifications" with respect To barricades, flagmen, flares, warning signs, and all responsibility for complaints or damage suits by traveling public and adjacent property owners.

1. Exaction material shall not be placed on road shoulders or traffic lanes or in ditches where drainage would be impaired. When excavation is permitted near the roadway where, in the opinion of the County, the support of the oil road structure is endangered, sheeting, cribbing, other measures shall be taken to prevent damage to the roadway or the creation of traffic hazard.
2. All excavations shall be backfilled in a neat and workmanlike manner and all disturbed areas shall be restored to a condition comparable to the original condition. Backfill material shall be consolidated to a density comparable to that of the adjacent undisturbed material, replacing all of the excavated material except that displaced by pipe. The degree of compaction shall be such as to prevent future settlement. Excess material displaced by the pipe shall be remove from the right-of-way or otherwise disposed of to the satisfaction of the county's representative. Pipe laying operation shall not be carried on when soil conditions are such that construction equipment will cause rutting. Backfill operations shall be kept within one mile of trenching and/or pipe laying operations.
3. Sod and/or other erosion control measures removed or disturbed by the installation shall be replaced. This shall include keeping separate and replacing existing topsoil, importing sod or seeding or a combination of these methods together with fertilizer and water as necessary to re-establish vegetative cover in a healthy and growing condition.
4. The pipe or, if encased, the encasement pipe shall completely fit the bored hole.
5. All private and commercial access driveways disturbed by pipe laying shall be restored to a condition comparable to that which existed prior to these operation. Special care shall be taken to compact backfill and base material to prevent future settlement. All work shall be completed to the owners satisfaction. All public access driveways with paved surfaces shall be crossed by the bored hole method. Crossings of dirt or gravel public access driveways may be made as specified for private and commercial access driveways except that provisions shall be made for uninterrupted flow of traffic.

6. No trees or shrubbery shall be cut or trimmed with the approval of the Panola County Road and Bridge Department.
7. Regulations and ordinances of incorporated cities shall be complied with if with the city limits.

APPROVAL

April 25, 2005

TO: Mr. Jim Northcott
Comstock Oil & Gas, L.P.
P. O. Box 281
Carthage, Texas 75633

RE: CR #241

The Panola County Commissioners' Court offers no objection to the location on the right-of-way of your proposed 4" line as shown by accompanying drawings and notice except as noted below.

It is expressly understood that the County Commissioners' Court does not purpose hereby, to grant any right, claim, title or easement in or upon this county road. It is further understood that in the future should for any reason the county need to work, improve, relocate, widen, increase, add to, or in any manner change the structure of this right-of-way, any required relocation of said lines shall be at the sole expense of owner.

All work on the county right-of-way shall be performed in accordance with the county instructions. The installations shall not damage any part of the road and adequate provisions must be made to cause minimum inconvenience to traffic and adjacent owners. Special specifications for placing this line are as follows:

1. All lines are to be installed a minimum of 36 inches below the flow line of the adjacent drainage or barrow ditch.
2. All excavation within the right-of-way and not under surfacing shall be backfilled by tamping in 6 inch horizontal layers. All surplus material shall be removed from the right-of-way and the excavation finished flush with surrounding natural ground.
3. Lines crossing under surfaced roads and under surfacing cross roads within the right-of-way shall be placed by boring. Boring shall extend from crown line to crown line. Gravity from sewer lines under roadways shall be cast iron pipe.
4. All lines, where practicable, shall be located to cross roadbed at approximately right angles thereto. No lines are to be installed under or within 50 feet of either end of any bridge. No lines shall be placed in any culvert or within 10 feet of the closest point of same.

5. Parallel line will be installed as near the right-of-way lines as is possible and no parallel line will be installed in the roadbed or between the drainage ditch and the roadbed without special permission of the Panola County Commissioners' Court.
6. Operations along roadbeds shall be performed in such manner that all excavated material be kept off the pavement at all times, as well as all operating equipment and materials. No equipment or installation procedures will be used which will damage any road surface or structures. The cost of any repairs to road surface, roadbed, structures or other right-of-way features as a direct result of this installation will be borne by the owner of this line.
7. Barricades, warning signs, lights, and flag man(men) when necessary shall be provided by the contractor or owner. One-half (1/2) of the traveled portion of the road must be open at all times.

Approved: David Z. Anderson
COUNTY JUDGE

COMMISSIONERS:

Precinct #1 Ronnie LaGrone
Precinct #2 Doug Cotton
Precinct #3 Hermon E. Reed, Jr.
Precinct #4 Dale LaGrone

PANOLA COUNTY, TEXAS

SION HARDIN SURVEY A-321

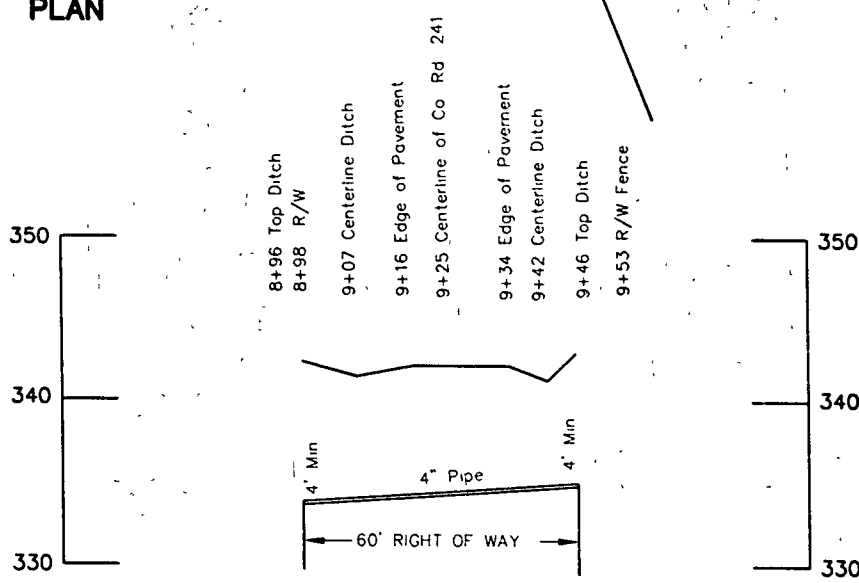
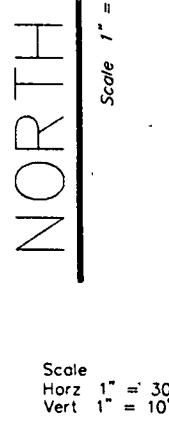
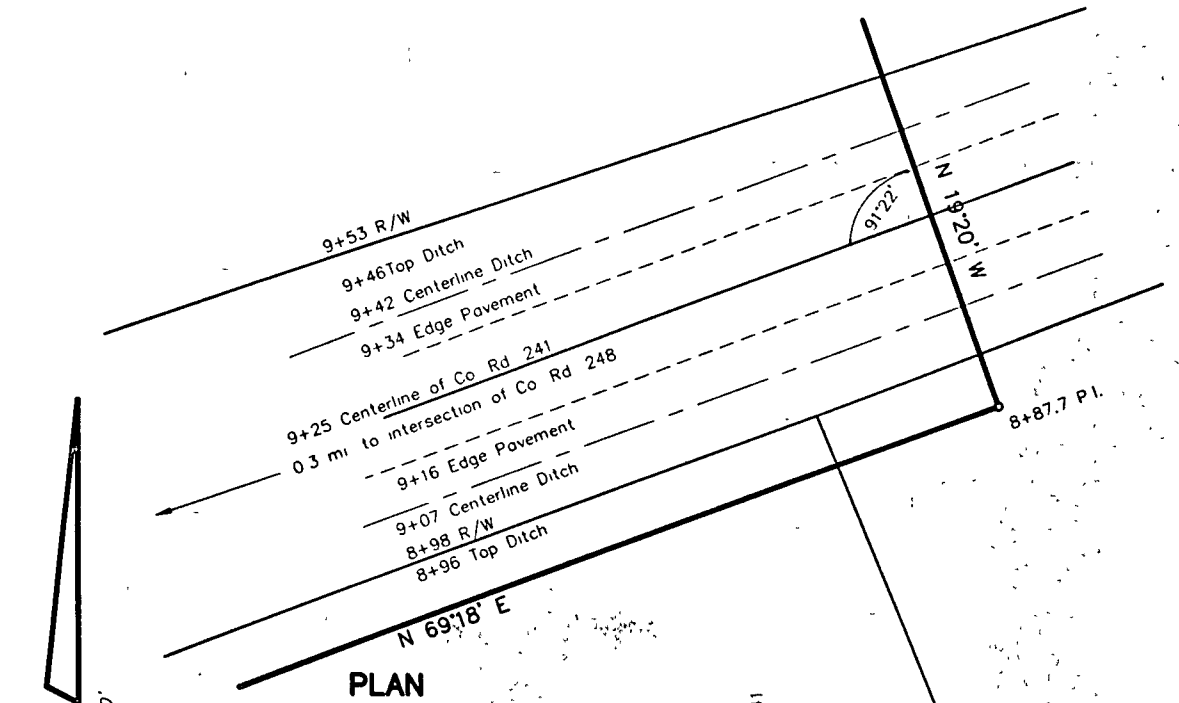

Scale
Horz 1" = 30'
Vert 1" = 10'

LEGEND

- Barbed Wire Fence — X —
- Chain Link Fence — O —
- Wood Fence — □ —
- Tele Cable — T —
- Powerline — E —
- Centerline — — —
- Pipeline — // —

PROFILE

PLAT SHOWING
**PROPOSED PIPELINE CROSSING
COUNTY ROAD NO. 241, LOCATED IN THE
SION HARDIN SURVEY, A-321
PANOLA COUNTY, TEXAS**

SURVEYING & MAPPING BY FISHER SURVEYING P.O. Box 1197 - Van, Texas 75790 (903) 963-3524		SURVEYED FOR COMSTOCK OIL & GAS, L. P.	
Scale 1"=30'	Drawn By DRF	Job No 1618A	PIPELINE FROM THE WALDROP 1 #3 TO WALDROP 1 #2
Date 4-08-2005	Surveyed By SC	Job No J1618A DWG	

**NOTICE OF PROPOSED INSTALLATION
PIPELINE AND /OR UTILITY LINES**

TO: THE PANOLA COUNTY COMMISSIONERS COURT

c/o

PANOLA COUNTY ROAD & BRIDGE DEPARTMENT CARTHAGE, TEXAS

Formal notice is hereby give that:

Devon _____ Proposes to place a
(COMPANY NAME)

4" Steel _____ Line within the Right-of-Way
(PIPE SIZE)

of County Road: 116 _____ as follows:
(NUMBER OF ROAD)

The proposed pipeline will cross under the indicated roads on the attached sheet. Installation shall be made by boring total length of line in Panola County is 150'.

The location and description of the proposed line and appurtenances is more fully shown by the copies of the drawings attached to this notice. The line will be constructed and maintained on the County Right-of-Way as directed by the County Commissioners in accordance with current Panola County Specifications.

Construction of this line will begin on or after the 14 day of
April 2005.

FIRM: Morgan Lake Construction, Inc.
BY: Don Freeman
TITLE: _____
ADDRESS: 5 Loop Carthage, Texas
PHONE: (903) 693-7380

**SPECIAL SPECIFICATIONS
FOR PIPE LINES CROSSING IN BORED HOLES
AND PLACED PARALLEL TO COUNTY ROADS**

GENERAL NOTE: The construction of this project shall follow "The Panola County Road and Bridge Department Standard Specifications" with respect To barricades, flagmen, flares, warning signs, and all responsibility for complaints or damage suits by traveling public and adjacent property owners.

1. Exaction material shall not be placed on road shoulders or traffic lanes or in ditches where drainage would be impaired. When excavation is permitted near the roadway where, in the opinion of the County, the support of the oil road structure is endangered, sheeting, cribbing, other measures shall be taken to prevent damage to the roadway or the creation of traffic hazard.
2. All excavations shall be backfilled in a neat and workmanlike manner and all disturbed areas shall be restored to a condition comparable to the original condition. Backfill material shall be consolidated to a density comparable to that of the adjacent undisturbed material, replacing all of the excavated material except that displaced by pipe. The degree of compaction shall be such as to prevent future settlement. Excess material displaced by the pipe shall be remove from the right-of-way or otherwise disposed of to the satisfaction of the county's representative. Pipe laying operation shall not be carried on when soil conditions are such that construction equipment will cause rutting. Backfill operations shall be kept within one mile of trenching and/or pipe laying operations.
3. Sod and/or other erosion control measures removed or disturbed by the installation shall be replaced. This shall include keeping separate and replacing existing topsoil, importing sod or seeding or a combination of these methods together with fertilizer and water as necessary to re-establish vegetative cover in a healthy and growing condition.
4. The pipe or, if encased, the encasement pipe shall completely fit the bored hole.
5. All private and commercial access driveways disturbed by pipe laying shall be restored to a condition comparable to that which existed prior to these operation. Special care shall be taken to compact backfill and base material to prevent future settlement. All work shall be completed to the owners satisfaction. All public access driveways with paved surfaces shall be crossed by the bored hole method. Crossings of dirt or gravel public access driveways may be made as specified for private and commercial access driveways except that provisions shall be made for uninterrupted flow of traffic.

6. No trees or shrubbery shall be cut or trimmed with the approval of the Panola County Road and Bridge Department.
7. Regulations and ordinances of incorporated cities shall be complied with if with the city limits.

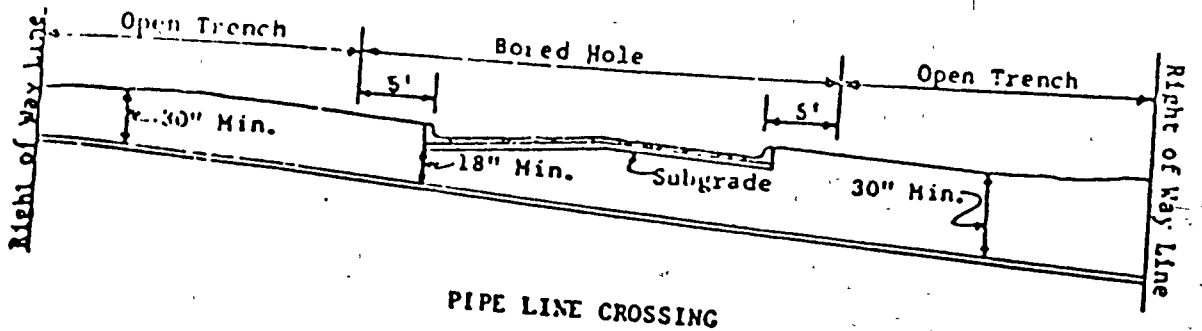
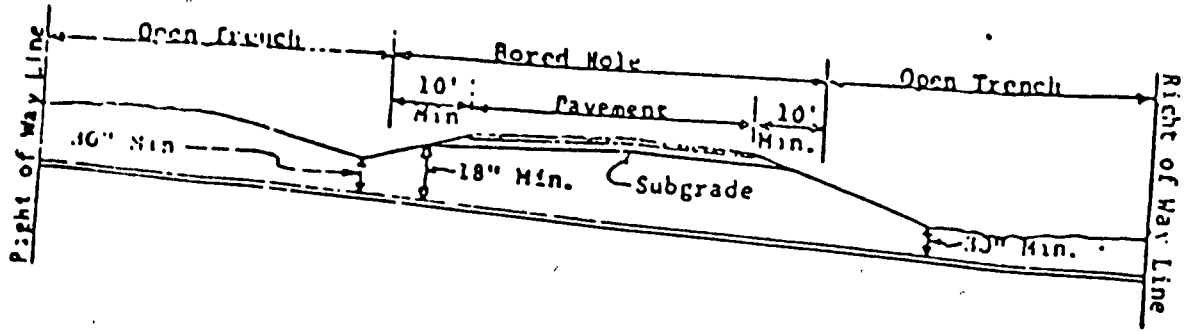

PIPE LINE CROSSING

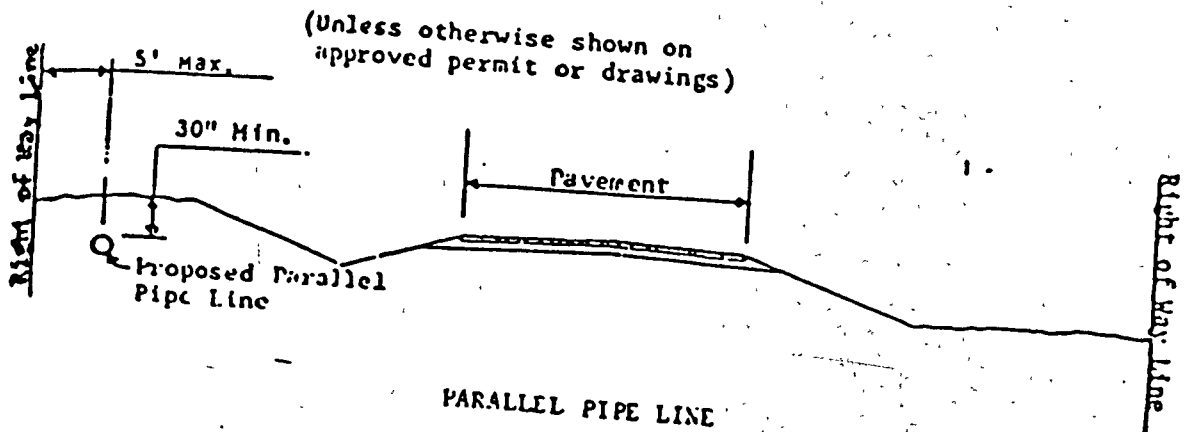

PARALLEL PIPE LINE

APPROVAL

April 25, 2005

TO: Devon
c/o Mr. Glen Reeves
Martin Lake Construction, Inc.
3206 SW Loop 436
Carthage, Texas 75633

RE: CR #116

The Panola County Commissioners' Court offers no objection to the location on the right-of-way of your proposed 4" steel line as shown by accompanying drawings and notice except as noted below.

It is expressly understood that the County Commissioners' Court does not purpose hereby, to grant any right, claim, title or easement in or upon this county road. It is further understood that in the future should for any reason the county need to work, improve, relocate, widen, increase, add to, or in any manner change the structure of this right-of-way, any required relocation of said lines shall be at the sole expense of owner.

All work on the county right-of-way shall be performed in accordance with the county instructions. The installations shall not damage any part of the road and adequate provisions must be made to cause minimum inconvenience to traffic and adjacent owners. Special specifications for placing this line are as follows:

1. All lines are to be installed a minimum of 36 inches below the flow line of the adjacent drainage or barrow ditch.
2. All excavation within the right-of-way and not under surfacing shall be backfilled by tamping in 6 inch horizontal layers. All surplus material shall be removed from the right-of-way and the excavation finished flush with surrounding natural ground.
3. Lines crossing under surfaced roads and under surfacing cross roads within the right-of-way shall be placed by boring. Boring shall extend from crown line to crown line. Gravity from sewer lines under roadways shall be cast iron pipe.
4. All lines, where practicable, shall be located to cross roadbed at approximately right angles thereto. No lines are to be installed under or within 50 feet of either end of any bridge. No lines shall be placed in any culvert or within 10 feet of the closest point of same.

5. Parallel line will be installed as near the right-of-way lines as is possible and no parallel line will be installed in the roadbed or between the drainage ditch and the roadbed without special permission of the Panola County Commissioners' Court.
6. Operations along roadbeds shall be performed in such manner that all excavated material be kept off the pavement at all times, as well as all operating equipment and materials. No equipment or installation procedures will be used which will damage any road surface or structures. The cost of any repairs to road surface, roadbed, structures or other right-of-way features as a direct result of this installation will be borne by the owner of this line.
7. Barricades, warning signs, lights, and flag man(men) when necessary shall be provided by the contractor or owner. One-half (1/2) of the traveled portion of the road must be open at all times.

Approved: David L. Anderson
COUNTY JUDGE

COMMISSIONERS:

Precinct #1 Ronnie LaGrone
Precinct #2 Doug Cotton
Precinct #3 Hermon E. Reed, Jr.
Precinct #4 Dale LaGrone

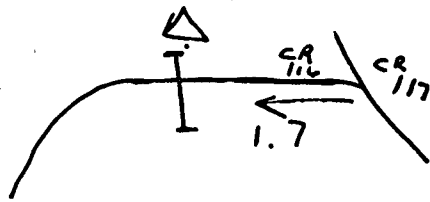

**NOTICE OF PROPOSED INSTALLATION
PIPELINE AND /OR UTILITY LINES**

TO: THE PANOLA COUNTY COMMISSIONERS COURT

c/o

PANOLA COUNTY ROAD & BRIDGE DEPARTMENT CARTHAGE, TEXAS

Formal notice is hereby give that:

Lacey Oil Co Proposes to place a
(COMPANY NAME)

4" Line within the Right-of-Way
(PIPE SIZE)

of County Road: CR 264 as follows:
(NUMBER OF ROAD)

The proposed pipeline will cross under the indicated roads on the attached sheet.
Installation shall be made by boring total length of line in Panola County is 174'

The location and description of the proposed line and appurtenances is more fully
shown by the copies of the drawings attached to this notice. The line will be constructed
and maintained on the County Right-of-Way as directed by the County Commissioners
in accordance with current Panola County Specifications.

Construction of this line will begin on or after the 4-19 day of
2005.

FIRM: Black Gold Operating
BY: Dean Williams
TITLE: Supervisor
ADDRESS: PO Box 161
Panola, Tex 75685
PHONE: (903) 926-5913

**SPECIAL SPECIFICATIONS
FOR PIPE LINES CROSSING IN BORED HOLES
AND PLACED PARALLEL TO COUNTY ROADS**

GENERAL NOTE: The construction of this project shall follow "The Panola County Road and Bridge Department Standard Specifications" with respect To barricades, flagmen, flares, warning signs, and all responsibility for complaints or damage suits by traveling public and adjacent property owners.

1. Exaction material shall not be placed on road shoulders or traffic lanes or in ditches where drainage would be impaired. When excavation is permitted near the roadway where, in the opinion of the County, the support of the oil road structure is endangered, sheeting, cribbing, other measures shall be taken to prevent damage to the roadway or the creation of traffic hazard.
2. All excavations shall be backfilled in a neat and workmanlike manner and all disturbed areas shall be restored to a condition comparable to the original condition. Backfill material shall be consolidated to a density comparable to that of the adjacent undisturbed material, replacing all of the excavated material except that displaced by pipe. The degree of compaction shall be such as to prevent future settlement. Excess material displaced by the pipe shall be remove from the right-of-way or otherwise disposed of to the satisfaction of the county's representative. Pipe laying operation shall not be carried on when soil conditions are such that construction equipment will cause rutting. Backfill operations shall be kept within one mile of trenching and/or pipe laying operations.
3. Sod and/or other erosion control measures removed or disturbed by the installation shall be replaced. This shall include keeping separate and replacing existing topsoil, importing sod or seeding or a combination of these methods together with fertilizer and water as necessary to re-establish vegetative cover in a healthy and growing condition.
4. The pipe or, if encased, the encasement pipe shall completely fit the bored hole.
5. All private and commercial access driveways disturbed by pipe laying shall be restored to a condition comparable to that which existed prior to these operation. Special care shall be taken to compact backfill and base material to prevent future settlement. All work shall be completed to the owners satisfaction. All public access driveways with paved surfaces shall be crossed by the bored hole method. Crossings of dirt or gravel public access driveways may be made as specified for private and commercial access driveways except that provisions shall be made for uninterrupted flow of traffic.

6. No trees or shrubbery shall be cut or trimmed with the approval of the Panola County Road and Bridge Department.
7. Regulations and ordinances of incorporated cities shall be complied with if with the city limits.

APPROVAL

April 25, 2005

TO: Lacy Oil Co.
c/o Mr. Dean Williams
Black Gold Operating
P. O. Box 161
Panola, Texas 75685

RE: CR #264

The Panola County Commissioners' Court offers no objection to the location on the right-of-way of your proposed 4" line as shown by accompanying drawings and notice except as noted below.

It is expressly understood that the County Commissioners' Court does not purpose hereby, to grant any right, claim, title or easement in or upon this county road. It is further understood that in the future should for any reason the county need to work, improve, relocate, widen, increase, add to, or in any manner change the structure of this right-of-way, any required relocation of said lines shall be at the sole expense of owner.

All work on the county right-of-way shall be performed in accordance with the county instructions. The installations shall not damage any part of the road and adequate provisions must be made to cause minimum inconvenience to traffic and adjacent owners. Special specifications for placing this line are as follows:

1. All lines are to be installed a minimum of 36 inches below the flow line of the adjacent drainage or barrow ditch.
2. All excavation within the right-of-way and not under surfacing shall be backfilled by tamping in 6 inch horizontal layers. All surplus material shall be removed from the right-of-way and the excavation finished flush with surrounding natural ground.
3. Lines crossing under surfaced roads and under surfacing cross roads within the right-of-way shall be placed by boring. Boring shall extend from crown line to crown line. Gravity from sewer lines under roadways shall be cast iron pipe.
4. All lines, where practicable, shall be located to cross roadbed at approximately right angles thereto. No lines are to be installed under or within 50 feet of either end of any bridge. No lines shall be placed in any culvert or within 10 feet of the closest point of same.

5. Parallel line will be installed as near the right-of-way lines as is possible and no parallel line will be installed in the roadbed or between the drainage ditch and the roadbed without special permission of the Panola County Commissioners' Court.
6. Operations along roadbeds shall be performed in such manner that all excavated material be kept off the pavement at all times, as well as all operating equipment and materials. No equipment or installation procedures will be used which will damage any road surface or structures. The cost of any repairs to road surface, roadbed, structures or other right-of-way features as a direct result of this installation will be borne by the owner of this line.
7. Barricades, warning signs, lights, and flag man(men) when necessary shall be provided by the contractor or owner. One-half (1/2) of the traveled portion of the road must be open at all times.

Approved: 
COUNTY JUDGE

COMMISSIONERS:

Precinct #1 Ronnie LaGrone
Precinct #2 Doug Cotton
Precinct #3 Hermon E. Reed, Jr.
Precinct #4 Dale LaGrone

Rock Hill Community

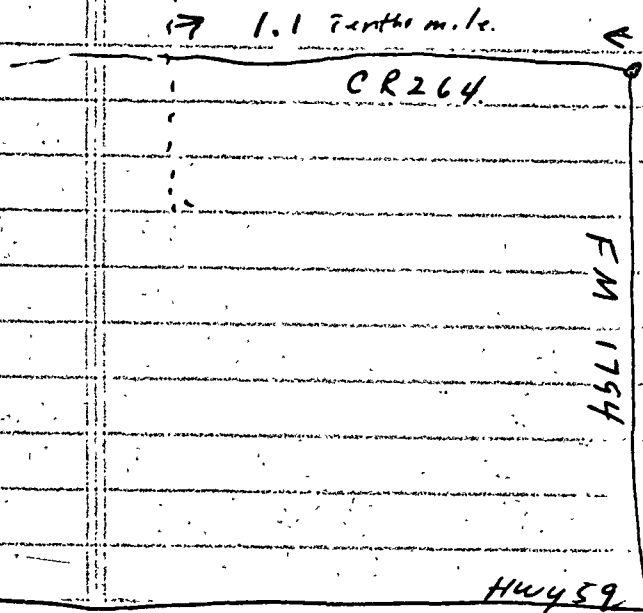

NOTICE OF PROPOSED INSTALLATION
PIPELINE AND /OR UTILITY LINES

TO: THE PANOLA COUNTY COMMISSIONERS COURT

do

PANOLA COUNTY ROAD & BRIDGE DEPARTMENT CARTHAGE, TEXAS

Formal notice is hereby give that:

Hopewell Operating Proposes to place a
(COMPANY NAME)
2" Pipe Line within the Right-of-Way
(PIPE SIZE)

of County Road 3311 is follows:
(NUMBER OF ROAD)

The proposed pipeline will cross under the indicated roads on the attached sheet.
Installation shall be made by boring total length of line in Panola County is 60 ft.

The location and description of the proposed line and appurtenances is more fully shown by the copies of the drawings attached to this notice. The line will be constructed and maintained on the County Right-of-Way as directed by the County Commissioners in accordance with current Panola County Specifications.

Construction of this line will begin on or after the 35th day of April 2005.

FIRM: B+O Service and Rental
BY: Bobby Beason
TITLE: owner
ADDRESS: PO Box 206
DeBerry TEXAS 75639
PHONE: (903) 766-2170

APPROVAL

April 25, 2005

TO: Hopewell Operating
c/o Mr. Bobby Beason
B & O Service and Rental
P. O. Box 206
DeBerry, Texas 75639

RE: CR #3311

The Panola County Commissioners' Court offers no objection to the location on the right-of-way of your proposed 2" pipe line as shown by accompanying drawings and notice except as noted below.

It is expressly understood that the County Commissioners' Court does not purpose hereby, to grant any right, claim, title or easement in or upon this county road. It is further understood that in the future should for any reason the county need to work, improve, relocate, widen, increase, add to, or in any manner change the structure of this right-of-way, any required relocation of said lines shall be at the sole expense of owner.

All work on the county right-of-way shall be performed in accordance with the county instructions. The installations shall not damage any part of the road and adequate provisions must be made to cause minimum inconvenience to traffic and adjacent owners. Special specifications for placing this line are as follows:

1. All lines are to be installed a minimum of 36 inches below the flow line of the adjacent drainage or barrow ditch.
2. All excavation within the right-of-way and not under surfacing shall be backfilled by tamping in 6 inch horizontal layers. All surplus material shall be removed from the right-of-way and the excavation finished flush with surrounding natural ground.
3. Lines crossing under surfaced roads and under surfacing cross roads within the right-of-way shall be placed by boring. Boring shall extend from crown line to crown line. Gravity from sewer lines under roadways shall be cast iron pipe.
4. All lines, where practicable, shall be located to cross roadbed at approximately right angles thereto. No lines are to be installed under or within 50 feet of either end of any bridge. No lines shall be placed in any culvert or within 10 feet of the closest point of same.

5. Parallel line will be installed as near the right-of-way lines as is possible and no parallel line will be installed in the roadbed or between the drainage ditch and the roadbed without special permission of the Panola County Commissioners' Court.
6. Operations along roadbeds shall be performed in such manner that all excavated material be kept off the pavement at all times, as well as all operating equipment and materials. No equipment or installation procedures will be used which will damage any road surface or structures. The cost of any repairs to road surface, roadbed, structures or other right-of-way features as a direct result of this installation will be borne by the owner of this line.
7. Barricades, warning signs, lights, and flag man(men) when necessary shall be provided by the contractor or owner. One-half (1/2) of the traveled portion of the road must be open at all times.

Approved: 
COUNTY JUDGE

COMMISSIONERS:

- Precinct #1 Ronnie LaGrone
- Precinct #2 Doug Cotton
- Precinct #3 Hermon E. Reed, Jr.
- Precinct #4 Dale LaGrone

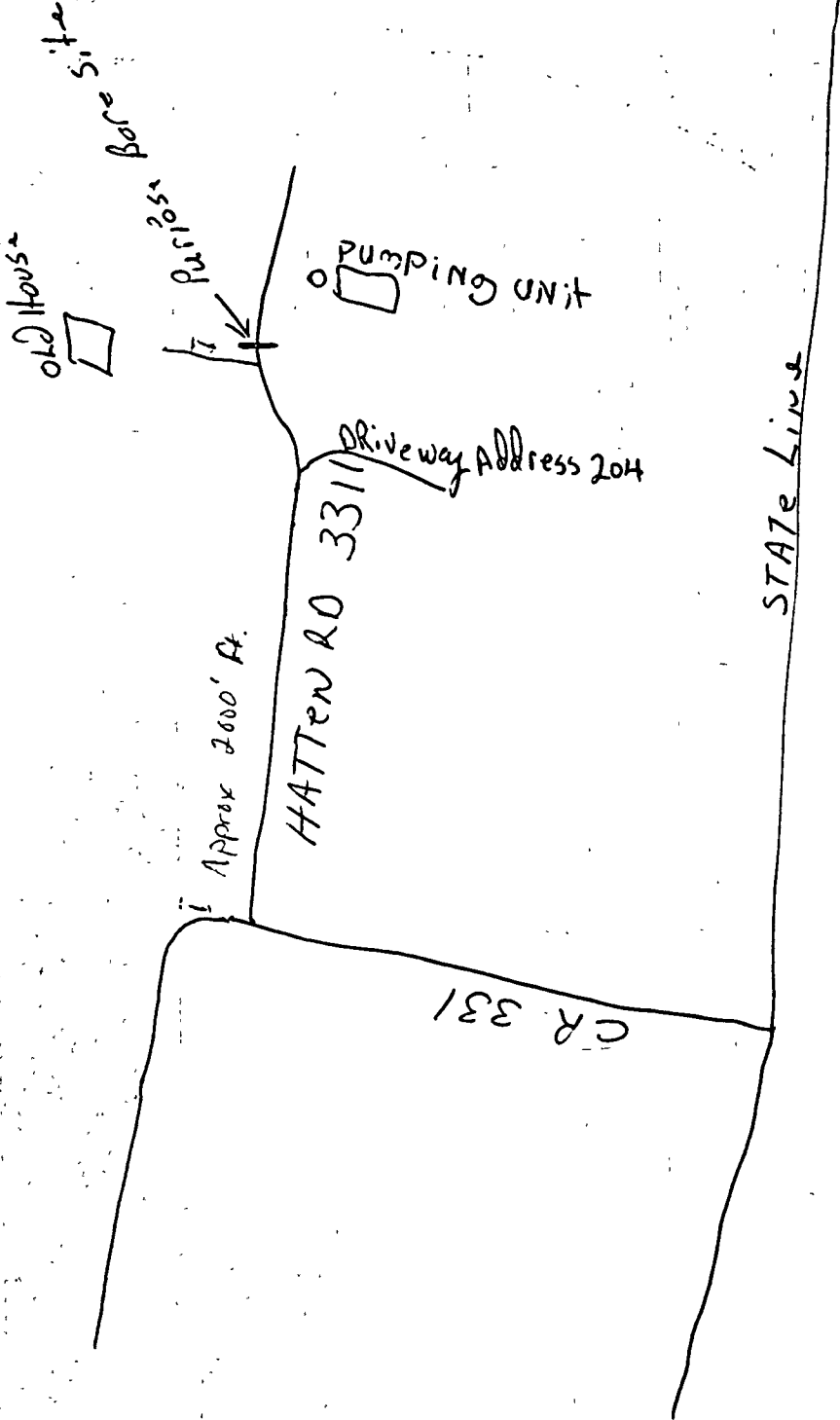

ThyssenKrupp Elevator



Date: April 12, 2005
 Attention: Fred Hightower
 Address: Panola County Courthouse
 110 Sycamore St.
 City: Carthage, TX 75633

Building: Panola County Courthouse
 Address: 110 Sycamore St.
 Carthage, TX 75633
 Contract #: 065-IF-02411
 Equipment #: 2 ea. Dover FE2817-0000
 1 ea. Otis

Purchaser authorizes ThyssenKrupp Elevator to perform the following described work on the subject elevator(s) in the above referenced building:

Our records indicate that the Annual Safety Test for your elevators is due during the month of May, 2005. The following is our proposal to have the annual safety test, as required by the State of Texas and the American National Standard Safety Code, witnessed by a QEI Inspector and certified with the State. This covers the cost of providing a QEI inspector plus coordination, notification, transportation, scheduling, handling, and processing.

The cost for providing the inspection and the additional services listed above will be ~~\$975.00~~. Inspection fees are not taxable. This does not include the filing fee for the Certificate of Compliance. **\$650.00**

ThyssenKrupp Elevator will exercise caution and care, in the performance of this testing, but will not be responsible for any damage done to the building structure or equipment occasioned by these tests.

IMPORTANT INFORMATION:

Once you have received your Inspection Report, you as the real property owner, or agent for the real property owner, are required by law to file a copy of each Inspection Report, one (1) per elevator or escalator, and a \$30.00 filing fee per unit, with: The Commissioner of the Texas Department of Licensing and Regulation Executive Offices, P.O. Box 12157, Austin, Texas 78711. There is a 60-day period from the actual date of inspection to comply with the TDLR letter of code violations.

If this proposal meets with your approval, please return one (1) signed copy to our office.

PLEASE SEND SIGNED REPAIR ORDER AND/OR ANY PRE-PAYMENTS TO THE TYLER OFFICE AT THE ADDRESS BELOW.

This Repair Order is submitted for acceptance within 30 days from the date executed by ThyssenKrupp Elevator.

Purchaser's acceptance of this Repair Order together with the terms and conditions printed on subsequent pages hereof and which are expressly made a part of this proposal and agreed to, and its approval by an executive officer of ThyssenKrupp Elevator will constitute exclusively and entirely the agreement for the work herein described. All prior representations or agreements regarding this work, whether written or verbal, will be deemed to be merged herein, and no other changes in or additions to this agreement will be recognized unless made in writing and properly executed by both parties. This Repair Order specifically contemplates work outside the scope of any maintenance contract currently in effect between the parties; any such contract shall be unaffected by this Repair Order.

No agent or employee shall have the authority to waive or modify any of the terms of this Agreement without the written approval of an authorized ThyssenKrupp Elevator manager.

Accepted:

PANOLA COUNTY COURTHOUSE

THYSSENKRUPP ELEVATOR CORPORATION
 100 East Ferguson, Suite 1103
 Tyler, TX 75702

By: David L. Anderson
 (Signature of Authorized Individual)

David L. Anderson
 (Printed or Typed Name)

Title: Co. Judge Date: 04-13-05

Contact Person: Fred Hightower

Telephone Number: 903-693-0318

Advance Notice Required? Yes No

By: Inge Gore
 (Signature of ThyssenKrupp Elevator Representative)

Inge Gore, QEI Coordinator
 (903) 533-8844, Fax (903) 533-8883

Date: 4-12-05

Approved by: _____

Title: _____ Date: _____

PANOLA COUNTY CRIMINAL DISTRICT ATTORNEY
STATE FORFEITURE FUND
BUDGET AMENDMENT
FISCAL YEAR 2005

SOURCE OF REVENUES

Cash Balance Beginning of Year	2,685
TOTAL	2,685

EXPENDITURES

Criminal District Attorney	
Supplies (no dumping/trespassing signs)	2,685
TOTAL	2,685

I hereby approve the above describe budget and ask the
Commissioners Court to please record it at the next scheduled
Commissioners Court Meeting.

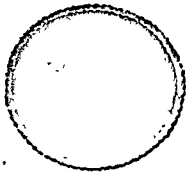

DANNY BUCK DAVIDSON

4/20/05
DATE

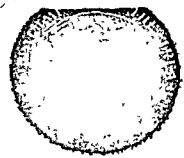

Federal Equitable Sharing Agreement

VALID THRU SEPTEMBER 30, 2008



Law Enforcement Agency: Panola County Sheriff's Department Check if New Participant

Police Department Sheriff's Office/Department Task Force (attach list of members) Prosecutor's Office Other _____

Contact Person: Captain Byron McMillen **E-mail Address:** b.mcmillen@co.panola.tx.us

Mailing Address: 314 W. Wellington St. Carthage, Texas 75633
(Street) (City) (State) (Zip Code)

Telephone Number: (903) 693-0333 **Fax Number:** (903) 690-0173

Agency Fiscal Year Ends on: 12/31/2005 **NCIC/ORI/Tracking No.:** TX1830000
(Month/Day)

This Federal Equitable Sharing Agreement entered into among (1) the Federal Government, (2) the above-stated law enforcement agency, and (3) the governing body sets forth the requirements for participation in the federal equitable sharing program and the restrictions upon the use of federally forfeited cash, property, proceeds, and any interest earned thereon, which are equitably shared with participating law enforcement agencies. By their signatures, the parties agree that they will be bound by the statutes and guidelines that regulate shared assets and the following requirements for participation in the federal equitable sharing program.

- 1. Submission.** The Federal Equitable Sharing Agreement and the Federal Annual Certification Report must be submitted to both the Department of Justice and the Department of the Treasury with a copy provided to the U.S. Attorney in the district in which the recipient law enforcement agency is located, in accordance with the instructions received from the respective departments or as outlined in their equitable sharing guidelines.

Asset Forfeiture and Money Laundering Section
 U.S. Department of Justice
 10th and Constitution Avenue, NW
 Bond Building, 10th Floor
 Washington, DC 20530
 Fax: (202) 616-1344
 E-mail address: afmls.aca@usdoj.gov

Executive Office for Asset Forfeiture
 U.S. Department of the Treasury
 740 15th Street, NW
 Suite 700
 Washington, DC 20220
 Fax: (202) 622-9610
 E-mail address: treas.aca@teof.treas.gov

- 2. Signatories.** This agreement must be signed by the head of the law enforcement agency and the head of the governing body. Examples of law enforcement agency heads include police chief, sheriff, director, commissioner, superintendent, administrator, chairperson, secretary, city attorney, county attorney, district attorney, prosecuting attorney, state attorney, commonwealth attorney, and attorney general. Examples of governing body heads include city manager, mayor, city council chairperson, county executive, county council chairperson, director, secretary, administrator, commissioner, and governor. Receipt of the signed agreement is a prerequisite to receiving any equitably shared cash, property, or proceeds.
- 3. Uses.** Any shared asset shall be used for law enforcement purposes in accordance with the statutes and guidelines that govern equitable sharing and as specified in the equitable sharing request (either a DAG-71 or a TDF 92-22.46) submitted by the requesting agency.
- 4. Transfers.** Before the undersigned law enforcement agency transfers cash, property, or proceeds to other state or local law enforcement agencies, it must verify first that the receiving agency has a current and valid Federal Equitable Sharing Agreement on file with both the Department of Justice and the Department of the Treasury. If there is no agreement on file, the undersigned law enforcement agency must obtain one from the receiving agency and forward it to the Department of Justice and the Department of the Treasury as in item 1. A list of recipients and the amount transferred must be attached to the Federal Annual Certification Report.

April 2005

5. Internal Controls. The parties agree to account separately for federal equitable sharing funds received from the Department of Justice and the Department of the Treasury. Funds from state and local forfeitures and other sources must not be commingled with federal equitable sharing funds. The recipient agency shall establish a separate revenue account or accounting code for state, local, Department of Justice, and Department of the Treasury forfeiture funds. Interest income generated must be accounted for in the appropriate federal forfeiture fund account.

The parties agree that such accounting will be subject to the standard accounting requirements and practices employed for other public monies as supplemented by requirements set forth in the current edition of the Department of Justice's *A Guide to Equitable Sharing of Federally Forfeited Property for State and Local Law Enforcement Agencies (Justice Guide)*, and the Department of the Treasury's *Guide to Equitable Sharing for Foreign Countries and Federal, State, and Local Law Enforcement Agencies (Treasury Guide)*. The accounting of shared funds must be reported on the Annual Certification Report.

The misuse or misapplication of shared resources or the supplantation of existing resources with shared assets is prohibited. Failure to comply with any provision of this agreement shall subject the recipient agency to the sanctions stipulated in the current edition of the *Justice or Treasury Guides*, depending on the source of the funds or property.

6. Federal Annual Certification Report. The recipient agency shall submit an Annual Certification Report to the Department of Justice and the Department of the Treasury (at the addresses shown in item 1) and a copy to the U.S. Attorney in the district in which the recipient agency is located. The certification must be submitted in accordance with the instructions received from the respective departments or as outlined in the *Justice or Treasury Guides*. Receipt of the certification report is a prerequisite to receiving any equitably shared cash, property, or proceeds.

7. Audit Report. Audits will be conducted as provided by the Single Audit Act Amendments of 1996 and OMB Circular A-133. The Department of Justice and the Department of the Treasury reserve the right to conduct periodic random audits.

8a. During the past 3 years, has your agency been found in violation of, or entered into a settlement agreement pursuant to, any nondiscrimination law in federal or state court, or before an administrative agency?

Yes No (If you answered yes, attach relevant information. See instructions.)

8b. Are there pending in a federal or state court, or before any federal or state administrative agency, proceedings against your agency alleging discrimination?

Yes No (If you answered yes, attach relevant information. See instructions.)

The undersigned certify that the recipient agency is in compliance with the nondiscrimination requirements of the following laws and their Department of Justice implementing regulations: Title VI of the Civil Rights Act of 1964 (42 U.S.C. § 2000d *et seq.*), Title IX of the Education Amendments of 1972 (20 U.S.C. § 1681 *et seq.*), Section 504 of the Rehabilitation Act of 1973 (29 U.S.C. § 794), and the Age Discrimination Act of 1975 (42 U.S.C. § 6101 *et seq.*), which prohibit discrimination on the basis of race, color, national origin, disability, or age in any federally assisted program or activity, or on the basis of sex in any federally assisted education program or activity.

Under penalty of perjury, the undersigned officials certify that the recipient state or local law enforcement agency is in compliance with the provisions of the *Justice and/or Treasury Guides* and the National Code of Professional Conduct for Asset Forfeiture.

Name (Print or Type) Jack Ellett Date _____
Law Enforcement Agency Head

Signature *Jack Ellett*

Title Sheriff

Name (Print or Type) David Anderson Date 4-19-05
Governing Body Head

Signature *David Anderson*

Title County Judge



Federal Annual Certification Report

This report must be submitted within 60 days after the close of your fiscal year to the:

Asset Forfeiture and Money Laundering Section
 U.S. Department of Justice
 10th and Constitution Avenue, NW
 Bond Building, 10th Floor
 Washington, DC 20530
 Fax (202) 616-1344
 E-mail address afmls_aca@usdoj.gov

Executive Office for Asset Forfeiture
 U.S. Department of the Treasury
 740 15th Street, NW
 Suite 700
 Washington, DC 20220
 Fax (202) 622-9610
 E-mail address treas_aca@eoaf.treas.gov

Law Enforcement Agency: Panola County Sheriff's Department
 Police Department Sheriff's Office/Department Task Force (attach list of members) Prosecutor's Office Other _____
 Contact Person: Captain Byron McMillen E-mail Address: b.mcmillen@co.panola.tx.us
 Mailing Address: (Street) 314 W. Wellington St. (City) Carthage (State) Texas (Zip Code) 75633
 Telephone Number: (903) 693-0333 Fax Number: (903) 690-0173
 Agency Fiscal Year Ends on: (Month/Day/Year) 12/31/2005 NCIC/ORI/Tracking No.: TX1830000

Summary of Equitable Sharing Activity (Fiscal Year Ending 2004)

	Justice Funds (DEA, FBI, etc) ¹	Treasury Funds (IRS, ICE, etc) ²
1. Beginning Equitable Sharing Fund Balance (must match Ending Equitable Sharing Fund Balance from prior FY) ..	\$ 0	\$ 0
2. Federal Sharing Funds Received from the Department of Justice and the Department of the Treasury	\$ 0	\$ 0
3. Federal Sharing Funds Received from Other Law Enforcement Agencies and Task Forces (complete attachment) ..	\$ 0	\$ 0
4. Other Income	\$ 0	\$ 0
5. Interest Income Accrued (<input type="checkbox"/> check if non-interest-bearing account)	\$ 0	\$ 0
6. Total Equitable Sharing Funds (total of lines 1 - 5)	\$ 0	\$ 0
7. Federal Sharing Funds Spent (total of lines a - n)	\$ (0)	\$ (0)
8. Ending Equitable Sharing Fund Balance (subtract line 7 from line 6)	\$ 0	\$ 0
9. Appraised Value of Other Assets Received	\$ 0	\$ 0

Summary of Shared Monies Spent

a. Total spent on salaries for new, temporary, not to exceed 1-year employees	\$	\$
b. Total spent on overtime	\$	\$
c. Total spent on informant and "buy money"	\$	\$
d. Total spent on travel and training	\$	\$
e. Total spent on communications and computers	\$	\$
f. Total spent on firearms and weapons	\$	\$
g. Total spent on body armor and protective gear	\$	\$
h. Total spent on electronic surveillance equipment	\$	\$
i. Total spent on building and improvements	\$	\$
j. Total spent on drug education and awareness programs	\$	\$
k. Total spent on other law enforcement expenses (complete attachment)	\$	\$
l. Total transfers to other state and local law enforcement agencies (complete attachment)	\$	\$
m. Total permissible use transfers (complete attachment)	\$	\$
Amount of line (m) used for drug abuse treatment and prevention programs	\$	\$
n. Total spent on matching grants (complete attachment)	\$	\$
o. Your agency's budget for current fiscal year	\$ 1,289,377.00	
p. Your jurisdiction's budget for current fiscal year	\$ 12,302,676.00	
q. Your agency's budget for prior fiscal year	\$ 1,207,221.00	
r. Your jurisdiction's budget for prior fiscal year	\$ 13,124,603.00	

Under the penalty of perjury, the undersigned hereby certify that the information in this report is an accurate accounting of funds received and spent by the law enforcement agency under the federal equitable sharing program during this reporting period.

Name (Print or Type) Jack Ellett Date 4/19/05
 Law Enforcement Agency Head
 Signature: [Signature]
 Title: Sheriff

Name (Print or Type) David Anderson Date 4-19-05
 Governing Body Head
 Signature: [Signature]
 Title: County Judge

This form is subject to the Freedom of Information Act and may be released under 5 U.S.C. § 552. See www.usdoj.gov/criminal/afmls.html or www.treas.gov/offices/enforcement/teofaf for additional forms.

¹ Include under Justice funds shared cash, proceeds, and property received from the Drug Enforcement Administration (DEA), Federal Bureau of Investigation (FBI), U.S. Attorney's Office, U.S. Postal Inspection Service, Food and Drug Administration, and U.S. Department of Agriculture.

² Include under Treasury funds shared cash, proceeds, and property received from the Bureau of Alcohol, Tobacco, Firearms and Explosives (ATF)*, Internal Revenue Service (IRS), U.S. Immigration and Customs Enforcement (ICE), U.S. Customs and Border Protection, U.S. Secret Service, and U.S. Coast Guard.

*The Bureau of Alcohol, Tobacco, Firearms and Explosives is a component of the Department of Justice, but ATF's equitable sharing is currently processed by the Department of the Treasury. Until further notice, please deposit all equitably shared cash and proceeds from ATF in your agency's Treasury fund.

April 2005

PANOLA COUNTY OFFICIAL/EMPLOYEE
REQUEST FOR ATTENDANCE AT A CONFERENCE

APPROVED
04-25-05

David L. Anderson
David L. Anderson,
County Judge

NAME: Gloria Portman
POSITION: County Treasurer
DEPARTMENT: County Treasurer
DATE: April 14, 2005

CONFERENCE: Personnel Issues
LOCATION: LSU - Shreveport, Louisiana
DATES: May 3, 2005 to May 3, 2005
NUMBER OF DAYS OUT OF OFFICE FOR THIS CONFERENCE: 1

Does the conference meet your educational requirements for the year? No

If not, how much of your requirements will be met by this conference? not sure

How much of your requirements have been met already, not counting this conference?
None, this year.

How many days have you been away from your job this year for conferences, not counting this conference? _____

Do you have sufficient funds in your budget for this conference? Yes

Write a short statement explaining the public purpose that will be met by your attendance at this conference: (continue on the back if necessary.)

This seminar will provide tips in dealing with various personnel issues.

PANOLA COUNTY OFFICIAL/EMPLOYEE
REQUEST FOR ATTENDANCE AT A CONFERENCE

APPROVED
04-25-05

David L. Anderson
David L. Anderson,
County Judge

NAME: Gloria Portman
POSITION: County Treasurer
DEPARTMENT: County Treasurer
DATE: April 14, 2005

CONFERENCE: Region 10 C TAT - Semi-annual Meeting
LOCATION: Lufkin, Texas
DATES: August 17, 2005 to August 17, 2005
NUMBER OF DAYS OUT OF OFFICE FOR THIS CONFERENCE: 1

Does the conference meet your educational requirements for the year? No

If not, how much of your requirements will be met by this conference? None

How much of your requirements have been met already, not counting this conference?
None, this year.

How many days have you been away from your job this year for conferences, not counting this conference? 1

Do you have sufficient funds in your budget for this conference? Yes

Write a short statement explaining the public purpose that will be met by your attendance at this conference: (continue on the back if necessary.)

This is a networking session of seventeen
treasurers.

PANOLA COUNTY OFFICIAL/EMPLOYEE
REQUEST FOR ATTENDANCE AT A CONFERENCE

APPROVED

04-25-05

David L. Anderson
David L. Anderson,
County Judge

NAME: Gloria Portman
POSITION: County Treasurer
DEPARTMENT: County Treasurer
DATE: April 14, 2005

CONFERENCE: Workers Compensation
LOCATION: Tyler, Texas
DATES: August 19, 2005 to August 19, 2005
NUMBER OF DAYS OUT OF OFFICE FOR THIS CONFERENCE: 1

Does the conference meet your educational requirements for the year? No

If not, how much of your requirements will be met by this conference? Not sure

How much of your requirements have been met already, not counting this conference?
None, this year.

How many days have you been away from your job this year for conferences, not counting this conference? _____

Do you have sufficient funds in your budget for this conference? Yes

Write a short statement explaining the public purpose that will be met by your attendance at this conference: (continue on the back if necessary.)

We should get updates on workers compensation,
at this seminar.

PANOLA COUNTY OFFICIAL/EMPLOYEE
REQUEST FOR ATTENDANCE AT A CONFERENCE

APPROVED
04-25-05
David L. Anderson
David L. Anderson,
County Judge

19 PAGE 255

NAME: Larima Roberts Pagster
POSITION: Court Administrator
DEPARTMENT: Panola County District Judge's Office
DATE: 4/15/05

CONFERENCE: 20th Annual Conference of the National Association Court Management
LOCATION: San Francisco, California
DATES: July 11, 2005 to July 14, 2005
NUMBER OF DAYS OUT OF OFFICE FOR THIS CONFERENCE: 5

Does the conference meet your educational requirements for the year? no
If not, how much of your requirements will be met by this conference? 21 hrs
How much of your requirements have been met already, not counting this conference?
none

How many days have you been away from your job this year for conferences, not counting this conference? none

Do you have sufficient funds in your budget for this conference? Yes

Write a short statement explaining the public purpose that will be met by your attendance at this conference: (continue on the back if necessary.)

To better understand issues involved in court management and to acquire knowledge, which would strength the relationship between court staff and litigants in order to more efficiently manage the court.

ACTION

ITEMS

Panola County
22 Apr 2005
THE SOFTWARE GROUP, INC.

ACCOUNTS PAYABLE SYSTEM

05:10:36pm

Open Invoices thru 04/25/05

PAGE 1

	Gross Amount.	Req. Req.	Discount Req. Req.	Net Amt.....
* Due 1301-ADAMS OIL COMPANY	\$41671.71	_____	\$0.00 _____	\$ 41671.71
* Due 1361-ANTI PEST CO INC	\$200.00	_____	\$0.00 _____	\$ 200.00
* Due 1491-ARS INC	\$1135.00	_____	\$0.00 _____	\$ 1135.00
* Due 2036-ATCO	\$222.84	_____	\$0.00 _____	\$ 222.84
* Due 2833-AUTO EXPRESS LUBE	\$193.16	_____	\$0.00 _____	\$ 193.16
* Due 2498-AVFUEL CORP	\$17796.11	_____	\$0.00 _____	\$ 17796.11
* Due 3885-BAXTER SALES - R&B	\$93.00	_____	\$0.00 _____	\$ 93.00
* Due 3598-BEEF	\$35.00	_____	\$0.00 _____	\$ 35.00
* Due 49-BEN E. KEITH	\$1800.00	_____	\$0.00 _____	\$ 1800.00
* Due 1541-BYRON MCILLEN	\$181.85	_____	\$0.00 _____	\$ 181.85
* Due 3894-C. MILLER DRILLING	\$6250.00	_____	\$0.00 _____	\$ 6250.00
* Due 209-CAR-TEX TRAILER COMPAN, IN\$43.90	\$43.90	_____	\$0.00 _____	\$ 43.90
* Due 2560-CARTHAGE DISCOUNT TIRE & \$64.00	\$64.00	_____	\$0.00 _____	\$ 64.00

Panola County
THE SOFTWARE GROUP, INC.

ACCOUNTS PAYABLE SYSTEM
Open Invoices thru 04/25/05

22 Apr 2005

PAGE 2

Gross Amount. Req. Req. Discount Req. Req. Net Amt.....

* Due 95-CARTHAGE OFFICE SUPPLY, INC	\$60.99		\$0.00		\$ 60.99
* Due 3434-CARTHAGE TRACTOR & EQUIP	\$83.08		\$0.00		\$ 83.08
* Due 3891-CELLULAR ONE - R & B	\$303.92		\$0.00		\$ 303.92
* Due 3892-CELLULAR ONE - SO	\$913.21		\$0.00		\$ 913.21
* Due 545-CHARLES C. DICKERSON	\$450.00		\$0.00		\$ 450.00
* Due 2639-CHEM CHEK INC	\$175.00		\$0.00		\$ 175.00
* Due 1932-CHIEF SUPPLY INC	\$347.79		\$0.00		\$ 347.79
* Due 37-CITY OF CARTHAGE	\$12.00		\$0.00		\$ 12.00
* Due 1143-COMPLETE PRINTING & PUB	\$2684.04		\$0.00		\$ 2684.04
* Due 256-CONLEY LOTT NICHOLS	\$95.45		\$0.00		\$ 95.45
* Due 3661-COOK TIRE & SERVICE CENT	\$644.64		\$0.00		\$ 644.64
* Due 28-CRAIG MILAN ELECTRIC	\$82.50		\$0.00		\$ 82.50
* Due 3769-CREATIVE MICRO SOLUTION	\$1070.00		\$0.00		\$ 1070.00

Panola County
THE SOFTWARE GROUP, INC.ACCOUNTS PAYABLE SYSTEM
Open Invoices thru 04/25/05

22 Apr 2005

PAGE 3

	Gross Amount.	Req.	Req.	Discount	Req.	Req.	Net Amt.....
* Due 452-DALLAS COUNTY TREASURER	\$5150.00			\$0.00			\$ 5150.00
* Due 775-DAVID BROOKS	\$100.00			\$0.00			\$ 100.00
* Due 528-DAVID GRAY	\$13.80			\$0.00			\$ 13.80
* Due 1906-DECISIONONE CORPORATION	\$18.72			\$0.00			\$ 18.72
* Due 3660-DISH NETWORK	\$59.98			\$0.00			\$ 59.98
* Due 201-DR.KEITH KEELING	\$500.00			\$0.00			\$ 500.00
* Due 3887-EAST TEXAS ALARM INC.	\$22.00			\$0.00			\$ 22.00
* Due 3470-ED BRANDO	\$973.28			\$0.00			\$ 973.28
* Due 2066-ETNC CARTHAGE	\$2839.15			\$0.00			\$ 2839.15
* Due 3026-ETOX	\$359.30			\$0.00			\$ 359.30
* Due 53-FUTURE EQUIPMENT CO INC	\$2008.74			\$0.00			\$ 2008.74
* Due 3015-GLASSPRO WINDSHIELD REPAIR	\$25.00			\$0.00			\$ 25.00
* Due 87-GOVERNMENT RECORDS SERVICE	\$8681.98			\$0.00			\$ 8681.98
* Due 1507-GRAY'S WHOLESALE TIRE DISCOUNT	\$508.24			\$0.00			\$ 508.24

Panola County
THE SOFTWARE GROUP, INC.

ACCOUNTS PAYABLE SYSTEM
Open Invoices thru 04/25/05

22 Apr 2005
PAGE 4

Gross Amount. Req. Req. Discount Req. Req. Net Amt.....

* Due 3002-GREGG COUNTY TREASURY	\$60.00		\$0.00		\$ 60.00
* Due 2850-HARRISON COUNTY JUVENIL	\$3600.00		\$0.00		\$ 3600.00
* Due 187-HART INTERCIVIC	\$399.50		\$0.00		\$ 399.50
* Due 370-HIGH POINT COMMUNICATIONS	\$59.56		\$0.00		\$ 59.56
* Due 3255-HOLT COMPANY OF TEXAS	\$3047.38		\$0.00		\$ 3047.38
* Due 3210-INDIGENT HEALTHCARE SOLU	\$945.00		\$0.00		\$ 945.00
* Due 1605-INDUSTRIAL OILS UNLIMITE	\$441.80		\$0.00		\$ 441.80
* Due 3710-INDUSTRIAL TOOL BOX	\$39.40		\$0.00		\$ 39.40
* Due 3283-J & M AIRCRAFT SUPPLY IN	\$153.25		\$0.00		\$ 153.25
* Due 2083-JAN MAXEY	\$125.09		\$0.00		\$ 125.09
* Due 1055-JEFF SCARBOROUGH	\$97.93		\$0.00		\$ 97.93
* Due 3600-JOE FOSTER	\$89.10		\$0.00		\$ 89.10
* Due 906-JOE NINS	\$18.28		\$0.00		\$ 18.28

Panola County
THE SOFTWARE GROUP, INC.ACCOUNTS PAYABLE SYSTEM
Open Invoices thru 04/25/05

22 Apr 2005

PAGE 5

	Gross Amount.	Req.	Req.	Discount	Req.	Req.	Net Amt.....
* Due 2520-JOHN F. NIELSEN, M.O.	\$75.00			\$0.00			\$ 75.00
* Due 1230-KATHY SLAGLE	\$18.57			\$0.00			\$ 18.57
* Due 943-KEVIN LAKE	\$152.00			\$0.00			\$ 152.00
* Due 3121-L. O. RESOURCES	\$402.55			\$0.00			\$ 402.55
* Due 286-LAW ENFORCEMENT SYSTEMS, I	\$87.00			\$0.00			\$ 87.00
* Due 3893-LSUS CONFERENCES & INSTI	\$149.00			\$0.00			\$ 149.00
* Due 1240-N.G. CLEANERS	\$173.50			\$0.00			\$ 173.50
* Due 3878-NELISSA ARENGDALE	\$450.00			\$0.00			\$ 450.00
* Due 2086-NICKEY DORNAN	\$134.09			\$0.00			\$ 134.09
* Due 699-NITCH NORTON	\$354.18			\$0.00			\$ 354.18
* Due 425-NORRIS SANFORD JR.	\$500.00			\$0.00			\$ 500.00
* Due 2148-NORRISON SUPPLY COMPAN	\$13288.00			\$0.00			\$ 13288.00
* Due 2785-NACOGDOCHES COUNTY SHERI	\$300.00			\$0.00			\$ 300.00

Panola County
THE SOFTWARE GROUP, INC.

ACCOUNTS PAYABLE SYSTEM
Open Invoices thru 04/25/05

22 Apr 2005
PAGE 6

	Gross Amount.	Req.	Req.	Discount	Req.	Req.	Net Amt.....
* Due 683-NATIONAL SHERIFFS' ASSOCI	\$100.00			\$0.00			\$ 100.00
* Due 3895-NEXTEL PARTNERS INC	\$148.06			\$0.00			\$ 148.06
* Due 3327-OFFICE DEPOT CARD PLAN	\$255.44			\$0.00			\$ 255.44
* Due 3202-OLNSTED-KIRK PAPER COMPS	\$1255.37			\$0.00			\$ 1255.37
* Due 3039-ONNIBASE SERVICES INC	\$468.00			\$0.00			\$ 468.00
* Due 3193-PANOLA COUNTY CHILD PRO	\$8000.00 R			\$0.00			\$ 8000.00
* Due 1190-PANOLA COUNTY JUVENILE	\$73597.00			\$0.00			\$ 73597.00
* Due 103-PEGUES-HURST MOTOR CO.	\$538.34			\$0.00			\$ 538.34
* Due 2471-PETTY'S LAWN SPRINKLERS	\$189.60			\$0.00			\$ 189.60
* Due 412-QUILL CORPORATION	\$157.96			\$0.00			\$ 157.96
* Due 3475-R. COLLIN UNDERWOOD	\$600.00			\$0.00			\$ 600.00
* Due 310-RADIO SHACK	\$14.99			\$0.00			\$ 14.99
* Due 20-RED MAN SUPPLY	\$10.53			\$0.00			\$ 10.53
* Due 525-RICK MCPHERSON	\$250.00			\$0.00			\$ 250.00

Panola County
THE SOFTWARE GROUP, INC.ACCOUNTS PAYABLE SYSTEM
Open Invoices thru 04/25/05

22 Apr 2005

PAGE 7

	Gross Amount.	Req.	Req.	Discount	Req.	Req.	Net Amt.....
* Due 619-RONNIE LAGRONE	\$1134.35	_____	_____	\$0.00	_____	_____	\$ 1134.35
* Due 3886-RUSH TRUCK CENTER	\$1581.50	_____	_____	\$0.00	_____	_____	\$ 1581.50
* Due 160-SABINE VALLEY CENTER	\$6050.00	_____	_____	\$0.00	_____	_____	\$ 6050.00
* Due 3807-SAFECO INSURANCE COMPANY	\$200.00	_____	_____	\$0.00	_____	_____	\$ 200.00
* Due 189-SBC	\$348.54	_____	_____	\$0.00	_____	_____	\$ 348.54
* Due 2823-SBC SOUTHWESTERN BELL	\$3804.20	_____	_____	\$0.00	_____	_____	\$ 3804.20
* Due 274-SIRCHIE	\$45.35	_____	_____	\$0.00	_____	_____	\$ 45.35
* Due 3666-ST PAUL TRAVELERS	\$127.00	_____	_____	\$0.00	_____	_____	\$ 127.00
* Due 2711-STEPHEN C. MAHAFFEY	\$5389.55	_____	_____	\$0.00	_____	_____	\$ 5389.55
* Due 2959-SUZZANE H. BLAKE MD	\$70.00	_____	_____	\$0.00	_____	_____	\$ 70.00
* Due 795-TERMINIX	\$97.50	_____	_____	\$0.00	_____	_____	\$ 97.50
* Due 2960-TERRY W. BLAKE PA-C	\$255.00	_____	_____	\$0.00	_____	_____	\$ 255.00
* Due 2801-TEXAS COUNTY PROGRESS TEX	\$17.50	Y	6	\$0.00	_____	_____	\$ 17.50

Panola County
THE SOFTWARE GROUP, INC.

ACCOUNTS PAYABLE SYSTEM
Open Invoices thru 04/25/05

22 Apr 2005

PAGE 8

	Gross Amount.	Req. Req.	Discount Req.	Req. Req.	Net Amt.....
* Due 3082-TEXAS PARKS & WILDLIFE	\$1093.10		\$0.00		\$ 1093.10
* Due 3399-TEXAS TRAUMA & EMERGENCY	\$172.00		\$0.00		\$ 172.00
* Due 3098-THE PRODUCTIVITY CENTER	\$600.00		\$0.00		\$ 600.00
* Due 161-THE SOFTWARE GROUP	\$1058.27		\$0.00		\$ 1058.27
* Due 2937-TIFCO INDUSTRIES	\$562.14		\$0.00		\$ 562.14
* Due 1990-TRI-STATE FASTENERS & SUP	\$62.71		\$0.00		\$ 62.71
* Due 1896-UNIFIRST	\$656.49		\$0.00		\$ 656.49
* Due 3031-UPSHUR COUNTY	\$16298.08		\$0.00		\$ 16298.08
* Due 1512-WASHCO INC	\$110.20		\$0.00		\$ 110.20
* Due 2533-WEST GROUP	\$720.00		\$0.00		\$ 720.00
* Due 149-WHOLESALE SUPPLY INC	\$265.00		\$0.00		\$ 265.00
* Due 64-XEROX CORPORATION	\$352.16		\$0.00		\$ 352.16
Totals	\$249685.57		\$0.00		\$ 249685.57

167 records listed.

Judge David Anderson
110 S. Sycamore
Carthage, Texas 75633

Dear Judge Anderson,

The Panola County Children's Services Board requests the Commissioners Court consider appointing Mrs. Ruth Bristow as a member of our Board. Mrs. Bristow retired as a teacher from the Beckville Independent School District and has completed all requirements for serving on the Board.

Thanking you in advance for your consideration.

Lisabeth S. Churchill

Lisabeth S. Churchill, Chairman
Panola County Children's Services Board

**PANOLA COUNTY
CHILDREN'S SERVICE BOARD**

APPOINTMENT

We, the Commissioners' Court of Panola County, Texas meeting in Special Session this 25th day of April, 2005 do hereby approve the appointment of the following person to the PANOLA COUNTY CHILDREN'S SERVICE BOARD:

Ruth Bristow.

Said appointment is effective immediately.

PASSED UNANIMOUSLY this 25th day of April, 2005 in Open Court.

David L. Anderson, County Judge

**RESOLUTION GRANTING REQUEST BY TXU MINING COMPANY LP
FOR PERMANENT ABANDONMENT OF COUNTY ROAD NO. 240
ALL OF WHICH IS SHOWN ON EXHIBIT "A", ATTACHED HERETO**

BE IT REMEMBERED, that the Commissioners' Court of Panola County, Texas met in Special Session on the 25th day of April, 2005, after due notice of meeting had been posted in the form, manner, and place required by law, with a quorum of its members present and participating in the meeting when, among other matters, the following came on to be considered, and action taken thereon, to-wit. The following were present:

David L. Anderson, County Judge of Panola County, Texas
Ronnie LaGrone, Commissioner of Precinct No. 1, Panola County, Texas
D. M. Cotton, Commissioner of Precinct No. 2, Panola County, Texas
Hermon E. Reed, Jr., Commissioner of Precinct No. 3, Panola County, Texas
Dale LaGrone, Commissioner of Precinct No. 4, Panola County, Texas.

Pursuant to published Agenda of said meeting, Commissioner Cotton offered the following resolution and moved its adoption, which was seconded by Commissioner R. LaGrone to-wit:

WHEREAS, TXU Mining Company LP is presently conducting surface mining operations for the production of lignite in Panola County, Texas in the vicinity of Panola County Road No. 240 at the existing location thereof as shown on Exhibit "A" attached hereto; and

WHEREAS, in order to mine the lignite located around and beneath the present right-of-ways of Panola County Road No. 240 as shown and identified on Exhibit "A" attached hereto, it will be necessary to abandon, close and discontinue Panola County Road No. 240; and

WHEREAS, the portion of Panola County Road No. 240 to be abandoned, closed and discontinued is more particularly described as beginning at the intersection of Panola County Road No. 240 and F. M. Road No. 1251 and extending north or northeasterly to its present termination point; and

WHEREAS, since TXU Mining Company, LP owns all the land adjacent to Panola County Road No. 240 as shown in Exhibit "A" attached hereto; permanent abandonment will not deprive any landowner of access to their property; and

WHEREAS, the Panola County Commissioners' Court has determined that the interest of the public and affected landowners have been protected as it relates to the permanent closing and abandonment of Panola County Road No. 240 as identified on the attached Exhibit "A";

NOW, THEREFORE, BE IT RESOLVED, by the Commissioners' Court of Panola County, Texas, that they approve of the permanent abandonment of Panola County Road No. 240 as shown on Exhibit "A" attached hereto, which such Exhibit "A" shows the beginning and termination points of the road to be permanently abandoned.

Upon vote, all voted "Aye" and none voted "No", and the County Judge declared the Resolution duly adopted. The above and foregoing is true and correct.

ADOPTED in Open Court this 25th day of April, 2005.

Ronnie LaGrone
Honorable Ronnie LaGrone
Commissioner, Precinct One

D. M. Cotton
Honorable Doug Cotton
Commissioner, Precinct Two

David L. Anderson
County Judge David L. Anderson

Hermon E. Reed, Jr.
Honorable Hermon E. Reed, Jr.
Commissioner, Precinct Three

Dale LaGrone
Honorable Dale LaGrone
Commissioner, Precinct Four

I, MICKEY DORMAN, County Clerk of Panola County, Texas, and Ex-Officio Clerk of the Commissioners' Court of Panola County, Texas, do hereby certify that the above and foregoing is a true and correct copy of the Resolution adopted by the Commissioners' Court of Panola County, Texas at a Special Session of said Court, held and conducted on the 25th day of April, 2005, as the same appears in the minutes thereof, and that said Resolution has not been amended, revoked, or rescinded.

GIVEN UNDER MY HAND AND SEAL OF OFFICE this 25th day of April, 2005.



Mickey Dorman
Mickey Dorman, County Clerk

VOL. 49 PAGE 259

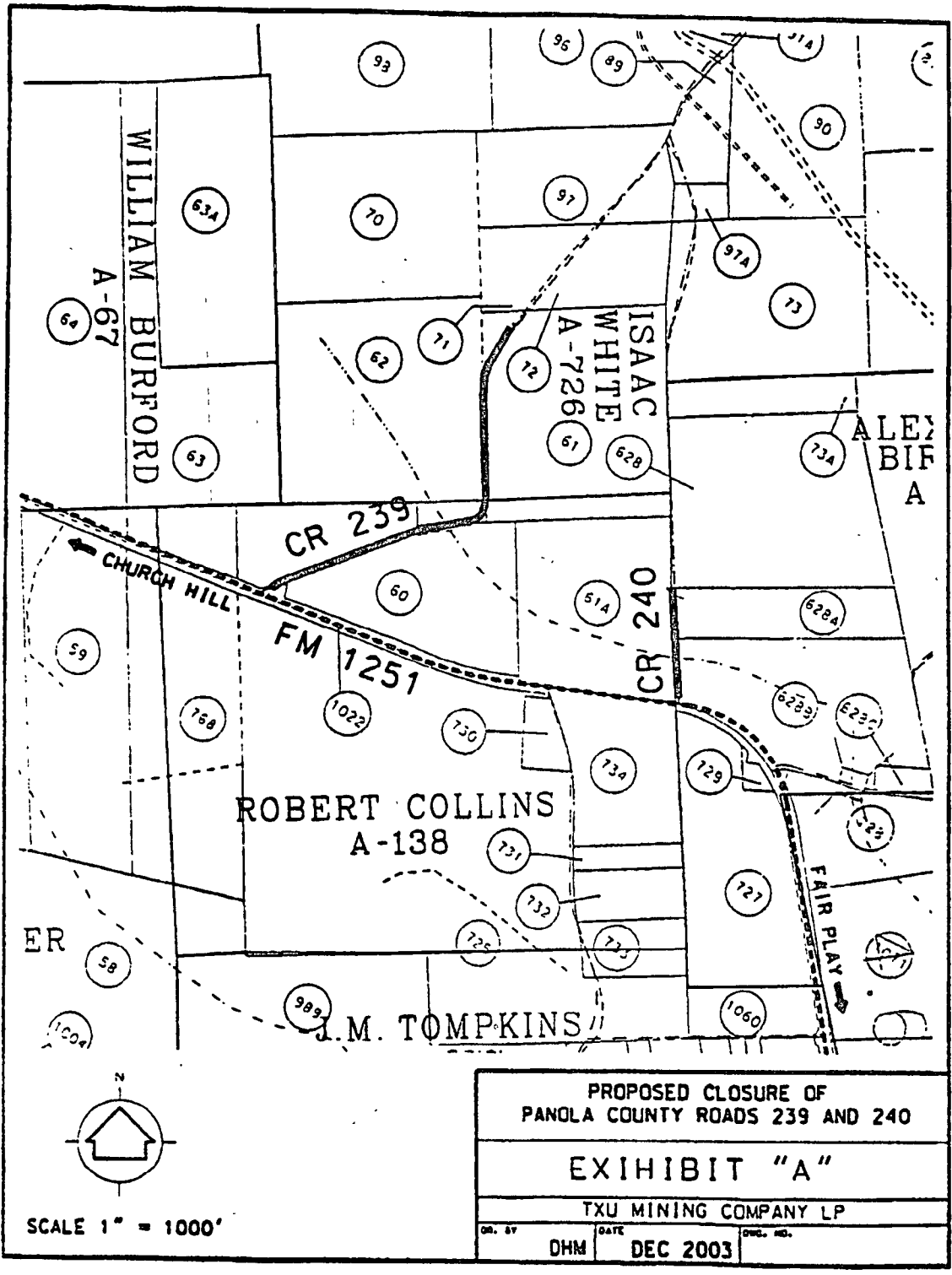

SCALE 1" = 1000'

PROPOSED CLOSURE OF
PANOLA COUNTY ROADS 239 AND 240

EXHIBIT "A"

TXU MINING COMPANY LP

DR. BY	DATE	DWG. NO.
DHM	DEC 2003	



**Purchase Agreement
Panola County
District Clerk**

April 20, 2005

Description	Quantity	Units	Unit Price	Ext. Price
AbleTerm Client Access License	1		\$199	\$199

Total (shipping charges included): **\$199**

Tyler Technologies
Prepared by: John Galbraith
6500 International Parkway
Suite 2000
Plano, Texas 75093
(800) 966-6999 / (972) 713-3777 fax
Attn: Jennifer Keltner

Panola County District Clerk

Panola County
Bill To (please print)

PO Number

David L. Anderson 4-25-05
Authorized Signature Date
David L. Anderson, Co. Judge

To Authorize This Purchase Agreement

- 1) Review Items for Accuracy
- 2) Complete 'Bill To' and 'Ship To' Information
- 3) Note any Special Instructions (i.e. expedite shipping, invoice asap, etc.)
- 4) Attach Your Purchase Order (if applicable, not required)
- 5) Sign and Fax to (972) 713-3777, Attn: Jennifer Keltner

Ship To Attention Of (please print)

Telephone

Ship To Address

Prices valid for up to 30 days from date of issue.

Special Shipping or Invoicing Instructions (if applicable)

PERSONNEL CHANGE REQUEST.

Name: Deland Wynn
Department: Panola County R+B Pctz
Position: Truck Driver

New Position
(if applicable): _____

Current wage or salary 9.61

New wage or salary 11.25

Effective date of change 4-26-05

Elected Official/Department Head
Signature

4-11-05
Date Signed

PERSONNEL CHANGE REQUEST

Name: Dale Downing
Department: Panola County R&B Pct 2
Position: Truck Driver

New Position
(if applicable): _____

Current wage or salary 9.61
New wage or salary 11.25
Effective date of change 4-26-05

D. M. C. [Signature]
Elected Official/Department Head
Signature

4-11-05
Date Signed

C. MILLER DRILLING CO.
"Water Wells Done Right"7355 East S H 154 - WINNSBORO, TX 75494 - USA
Phone 903-725-6970 - Fax 903-725-3647

April 19, 2005

To Whom It May Concern:

The change in price for the water well at Panola County was due to state regulation. With limitations at the airport on location to place the well and still have reasonable access to waterlines and electricity. It was agreed upon prior to drilling the well to place it between 50 to 100 feet for an old septic system. This required C. Miller Drilling to pump an additional 100 feet of cement between the outside of the casing and the bore hole. I have adjusted the cost of the well down to our actual expense for the additional work. This is the reason for the change in price from original estimate. The new invoice will show as follows: Cement top 100 feet due to location of old septic lines and well \$295.00. Depth increase of 20 feet \$20.00. and finally a credit amount of \$65.00 to adjust bill to agreed amount. If you have any further questions, please feel free to call us anytime. Again we thank you for your business.

Sincerely,

C. Miller Drilling

VOL.

49 PAGE 304



The Pipeline Group™

4400 N. Big Spring Ste B-21 Midland, Texas 79705
(432) 685-1731 FAX (432) 683-4938
www.pipelinegroup.com

April 15, 2005

Panola County Extension Office
Attn: Kathy Brown
110 S Sycamore Rm 102-A
Carthage TX 75633

Dear Kathy:

Enclosed is my check in the amount of \$100 for a donation to enable Panola County to purchase new tables for your building.

We look forward to holding our program at your facility in 2006 and using your new tables!

Sincerely,

A handwritten signature in cursive script that reads "LeNita Harmon".

LeNita Harmon
Manager, "Public Education-Contractor Awareness Program"

Enc.

Donation Acceptance

I/we, being desirous to contribute a donation to Panola County for the Panola County Exposition Center and/or General Fund hereby donate the following:

\$100.00.

This donation is to be used for tables for the exposition center or if no purpose is indicated, the purpose shall be determined by the Commissioners' Court. All purposes must be in accordance with current laws governing such funds. The Panola County Commissioners' Court according to Local Gov't. Code, Section 81.032, must accept this donation.

I/we acknowledge that this is given as a donation and that I/we have not been promised any other benefit because of the donation, nor have I/we been induced or coerced in any way by any official or employee of Panola County. I/we further certify that this donation is given freely and voluntarily.

Date: April 21, 2005

The Pipeline Group Name of Firm

(Signed) Ronni La Gue Panola County Representative

Sworn to and subscribed before me this 25th day of April, 20 05.

Lee Ann Jones
Notary Public, State of Texas
My Commission Expires: 12-10-2008

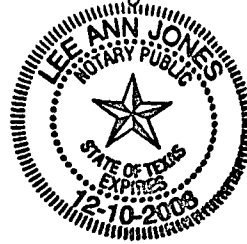

[Panola County Use Only]

This item was accepted/~~disapproved~~ (strike one) at a meeting of the Panola County Commissioners' Court on this 25th day of April, 2005.

County Judge David L. Anderson
David L. Anderson

VOL. 49 PAGE 306

Attn: Judge Anderson

From: Tammy Mitchum
Shelby Co. CSCD

This is the revised copy of the narrative form of the grant. If you need anything else or have any questions let me know.

Tammy M.

VOL. 49 PAGE 307

Project Narrative Forms

Legal Name of Organization:	Panola County		
Title of Project:	Drug Court Program (state)		
Grant Period:	From:	9/1/2005	To: 8/31/2006
Current Grant Number (If Continuation):	17470-01		

PART 1: PROBLEM STATEMENT AND DATA

1.1 Problem Statement

Provide a brief statement of the specific problem or problems this project is designed to address

Enter text here . do not exceed the maximum allowed area within the text box.

The 123rd Judicial District, population 48,488 (Panola and Shelby Counties) is located 175 miles northeast of Houston, Texas, on a drug trafficking corridor that follows US Highway 59 North. Highway 59 North is connected to Interstate 20 and Interstate 30. Prison overcrowding, community supervision, drug dependency treatment and judicial intervention has not reduced recidivism rates among dependent drug offenders. Crack Cocaine was once the drug users preference in the 123rd Judicial District. In past years the 123rd Judicial District's most often abused drug was "crack" cocaine. This drug has proven to be extremely addictive. The 123rd Judicial District is currently facing a new drug epidemic, methamphetamine. The North Texas Narcotics Task Force stated, during a recent seminar, that methamphetamine has become the most abused drug in their district. Methamphetamine abusers have a 24 hour "high", compared to a crack cocaine "high" of a few hours. The North Texas Narcotics Task Force considers methamphetamine more addictive than "crack" cocaine. A program that offers stringent supervision and counseling needed. The Drug Court program would offer the judges in our district an opportunity to punish and rehabilitate non-violent drug offenders in a closely monitored setting. Review of the literature on drug court successes in these areas convinced the courts of the need for a drug court, we are in the beginning phases, so application is being made for continuing assistance through the LLEBG-Rural Drug Court Initiative(CFDA-16.18.592).

VOL. 49 PAGE 368

Project Narrative Forms

1.2 Supporting Data

Provide data that supports the problem. Use only data that is verifiable and relevant to your target population. The data should be derived from baseline statistics. For example, do not use statewide data for a local problem and do not use national data for a statewide problem. Also, provide citations for the sources of your data.

Enter text here. Do not exceed the maximum allowed area within the text box.

The volume of arrests in the 123rd Judicial District is an indicator of the need for a program like drug court. In FY 2004 of the 1815 arrests in Panola County 192 were Drug related, 112 were Driving While Intoxicated. The same time period 1571 arrests were made in Shelby County 157 were Drug related 120 were Driving While Intoxicated. The statistics were compiled by the Shelby and Panola County Sheriff's Departments. It is estimated that 50% (174) of the drug related offenses would be eligible for community supervision and 70% (162) of the DWI's would be eligible for community supervision. Due to the careful screening process it is estimated that 20% (67) would have been eligible for the Drug Court program. The CSCD provides quality gender-specific supportive outpatient substance abuse counseling, cognitive behavior services through an in house program, while making referral for co-occurring problem Substance dependent probationers (target population for drug court) are referred to East Texas Council on Alcohol and Drug Abuse (ETCADA) or Alcohol Drug Abuse Council (ADAC). In 2004, there was an average 2-4 week delay between evaluation and entry into a treatment program. Currently the average delay is 6-12 weeks for entry into a treatment program. Officers understand the importance of a treatment team approach to supervision, but high case loads preclude this option. The current judicial case processing system does not allow for court settings to celebrate successes in supervision, probationers receive only negative feedback and negative consequences for failures. The Drug Court will use a Management Information System by the name of Buffalo. This system was designed by the Buffalo, New York and Jacksonville, Florida Drug Courts. Buffalo addresses all concerns of the Drug Court. Also, demographics of the arrestee population will be monitored. An online report will be incorporated into the Management Information System (MIS), allowing drug court staff to monitor the race, ethnicity, age, and gender composition of drug court participants, versus the arrestee populations at the time admissions are made. In the event bias is uncovered, CSCD will re-evaluate the screening process, improving or changing the instruments as needed and providing technical or diversity training for personnel.

Project Narrative Forms

13 Community Plan

If this is a local or regional project, the grant applicant must have participated in a local community planning process or the proposed project has to be in response to priorities set in a community plan. IDENTIFY what priority(ies) this project addresses within your community plan. (See T.A.C. §3.51)

Enter text here.. do not exceed the maximum allowed area within the text box.

A priority that is set forth in the Community Justice Plan's mission statement is to enhance public safety by providing our courts with viable risk control management alternatives for criminal offenders, while making opportunities available to facilitate positive changes, should the offender choose to participate. Our project is at the very heart of the community plan's mission statement. The Drug Court uses behavior modification techniques along with intensive supervision to help offenders make a positive change. Offenders will have mandatory individual and group counseling. Offenders will also be subjected to GED or technical training classes if necessary to maintain employment. Full time employment by offenders could lead to a vocational skill. Offenders will have classes in cognitive thinking and have goals, rewards or sanctions as needed. For the first time in their lives, offenders will have a set of rules set out before them and a team of professionals to make sure that they are enforced and reinforced. Offenders will have the support and the boundaries to lead a drug free and productive life, free of criminal behavior. This program is the alternative for offenders who want a positive change in their lives.

VOL. 19 PAGE 309

VOL. 49 PAGE 310

Project Narrative Forms

PART 2: GOAL STATEMENT

Based on your problem statement, provide a brief goal statement. It should be a general statement reflecting the overall impact that you intend the project to attain. Do NOT list activities in the goal.

Enter text here do not exceed the maximum allowed area within the text box

The goal of this project is to reduce offender recidivism in our communities by implementing an intensive drug court program. Our goal is to keep offenders drug and alcohol free, reduce recidivism and maintain a substance-free lifestyle through a non-adversarial court approach. A 50% drop in substance abuse is anticipated, as measured by intoxilyzer/urine screen results. We project criminal activity will be lowered by 30% up to three years after completion, as measured by criminal history record checks. Assessment scores are expected to show a 20% improvement in social functioning, employment stability, educational attainment, relationship stability, amenability to treatment, and self-satisfaction. Drug court participants will enter treatment 50% faster than other probationers. Outcomes will be measured through a comprehensive drug court and outcome evaluation. Goals to meet: Members of the Shelby County Drug Court Team have been hired. The Panola County Drug Court Team is one member short of being complete, but interviews are being held. Formal training for both Drug Court Teams is ongoing. Drug Court Team training which has been completed includes, (1) MS training, (2) Community Supervision Officer Certification (3) Drug Court Sustainability, (4) HIV/Tuberculosis Training (5) Drug Court Defense Counsel Training and (6) Panola County Methamphetamine Training.

Project Narrative Forms

PART 3: TARGET GROUP

Briefly explain the target group for your project. Include the geographic area targeted, the target audience, and the relevant characteristics of those persons

3.1 Geographic Area

Enter text here do not exceed the maximum allowed area within any of the text boxes

Our target geographic area is Rural East Texas, primarily Panola and Shelby Counties which make up the 123rd Judicial District. U S Highway 59 runs through much of our district and contributes to the targeting of this area, due to the large amount of drug trafficking

3.2 Target Audience

All drug related offenses will be included Driving While Intoxicated (DWI), Possession of a Controlled Substance (POCS), Violation of Community Supervision, (VOP) etc and any other offense that were committed while under the influence of a drugs, such as burglary of a building or any offense which was committed to obtain money for drugs, such as forgery of a check. Any offender charged with a violent offense (Assault) in the past will not be considered. These are the offenses of our target audience.

3.3 Gender

Male and female participants will be considered equally for entry into drug court.

3.4 Ages

All participants entering into this drug court must be at least 17 years of age or older. There is no age limit in this program

3.5 Special Characteristics

All participants must want help. Participants must want to make a change in their life. No participant will ever be forced into drug court, the program will work the best for people who truly desire a positive change in their lives.

VOL. 49 PAGE 312

Project Narrative Forms

PART 4: PROJECT ACTIVITIES

4.1 Program Type

Designate the Program Type that best describes the primary purpose for this project. Definitions are located in the *Application Instruction Kit*. Note: Active program types will vary by fund source. While you can view all Program Types, you can only select one that is active for this fund source (SELECT only one)

- Alternative Sanctions
- Training/Education
- Treatment/Counseling

Other (Specify):

4.2 Activity Description

Describe the activities or services your project provides. Be sure the activities support the goal statement and are consistent with the selections made in the Fund-Specific Criteria tab

Enter text here do not exceed the maximum allowed area within the text box

The 123rd Judicial District Adult Drug Court offers many services. An inpatient/residential substance abuse treatment facility is available to participants. Available facilities include, (1) TAIP, (2) SAFFP or (3) halfway house. These facilities would offer the tools and techniques to avoid alcohol and drugs. Also, provided is aftercare/relapse prevention through group and individual counseling. Participants will work on individual set goals. Participants will receive individual counseling from a licensed drug court counselor. The counselor also involves family and spouse individual counseling sessions. The Drug Court Counselor will provide a weekly parenting class to participants. Participants will learn to set boundaries, enforce rules and discipline in an appropriate manner, so as to stop the cycle of substance abuse. The drug court also offers group/peer counseling in several settings, the aftercare classes, the drug education classes and the cognitive behavioral modification classes. Another aspect of the program which offers group/peer counseling is the NAA program which drug court sponsors. There are two classes per week for participants and any other probationer with drug or alcohol problems. The drug court also offers mental health/individual diagnosis services through the Burke Center in Nacogdoches, Texas. The program also offers assistance/referrals with health care. The Drug Court has agreements with local physicians, to provide low cost health care. The Drug Court provides educational pamphlets and flyers to participants concerning health problems associated with drug and alcohol abuse. Local churches have also agreed to give classes on life skills and an invitation to services for spiritual support. While these classes are made available to clients they are not mandatory. The Drug Court program works with Panola College to offer basic adult education, GED assistance, technical training, and job training. The Texas Workforce Commission accepts referrals for employment opportunities. These are the services offered to Drug Court participants.

Project Narrative Forms

PART 5. PROJECT OBJECTIVES

5.1 Performance Measures

Provide both output and outcome measures for this project. Output measures show the level of activity of a project. They reflect the amount of services being provided (e.g., number of people served, number of classes held). They are not intended to show impact. Outcome measures show impacts of a project in targeted areas (e.g., percentage of program graduates). They reflect the extent to which the goals of the project have been achieved

	<u>Current Annual Activity</u>	<u>Target Level of Activity for the Grant Period</u>
Output Measures - Required for All Projects		
Enter text here - do not exceed the maximum allowed area within any of the text boxes Number of drug court staff that will receive any professional training during the grant period (professional training includes conferences, workshops, and tech. assistance on drug court issues. Staff means any member of the drug court team including the judge)	0	13
Number of people assessed for eligibility to participate in the drug court program	9	20
Number of new enrollments in the program	4	10
Number of participants (Participants would include the number in the program at the beginning of the grant period plus the number of enrollments, i.e., total number served. This number will be the same as "new enrollments" for drug courts.)	4	23
Outcome Measures - Required for All Projects		
Enter text here - do not exceed the maximum allowed area within any of the text boxes Number of participants that earn a GED or high school diploma while in the program	new drug court	2
Number of participants that earn a one year certificate through vocational training while in the program	new drug court	2
Number of participants that successfully gain and retain employment while in the program	new drug co	8
Number of participants that successfully complete the program (graduated or completed the term of probation)	new drug co	5

VOL. 49 PAGE 314

Project Narrative Forms

5.2 Continuation Projects

For continuation projects only, if your current or previous year's project is NOT on schedule in accomplishing the stated objectives, briefly describe the major obstacles preventing your organization from successfully reaching the project objectives as stated within your previous grant application (Data may be calculated on a pro-rated basis depending on how long the current or previous year's project has been operating)

Enter text here ..do not exceed the maximum allowed area within the text box.

Goals stated Members of the Drug court team must be identified within the next 30 days Proper training must be scheduled for a successful Drug Court transition. The local drug court staff has ongoing training as training become available, and the treatment infrastructure is being established. The 123rd Judicial District had planned on receiving approval to establish a drug court by January 02, 2005 Due to a delay in approval, the drug court staff was not hired until March 2005 The drug court team has been collaborating with established drug courts in Texas and has gained valuable tips and parameters that will help this drug court to be successful The team currently is registered for the Drug Court training scheduled for May 9th and 10th in Austin Texas.

VOL. 49 PAGE 315

Project Narrative Forms

PART 6: PROJECT SUMMARY

Briefly summarize the entire application, including the project's problem statement, supporting data, goal, target group, activities, and objectives. Be sure that the summary is easy to understand by a person not familiar with your project and that you are confident and comfortable with the information if it were to be released under a public information request.

Enter text here do not exceed the maximum allowed area within the text box.

The 123rd Judicial District is located near Houston Texas and on U S Highway 59 This area is heavy in drug trafficking Drugs are in abundance in East Texas, as are drug abusers The overcrowding in Texas prisons have made the Courts attempts to lessen the abuse of drugs and crime ineffective In the last fiscal year the district had 581 arrests for drug or alcohol related crimes. Our goal as a Drug Court is to enhance public protection, while offer a risk controlled, treatment alternative for drug abuse. This goal will help create a better community for everyone This program will help drug abuse by helping participants remain drug free and help the rest of the community by eliminating the crime that comes with drug abuse and drug abusers maintain employment and sobriety The Drug Court will target male and female above 17 years of age, who have an identified drug or alcohol problem, with no history of violence The Drug Court will offer assistance in several areas. psychological counseling in individual, fam and group settings, basic adult education, GED preparation, technical training, job searches, health care, AANA classes, parenting classes, relapse prevention and if desired spiritual support. The Drug Court Program will incorporate all of these parts into a cohesive, life bettering movement, which should improve all the communities involved.

RECORDED _____ O'CLOCK _____ M. ON THE _____ DAY OF _____ 2005

MICKEY DORMAN, COUNTY CLERK, P.C.T. Mickey Dorman

